

(North Alabama)

HALLEY LEAVES

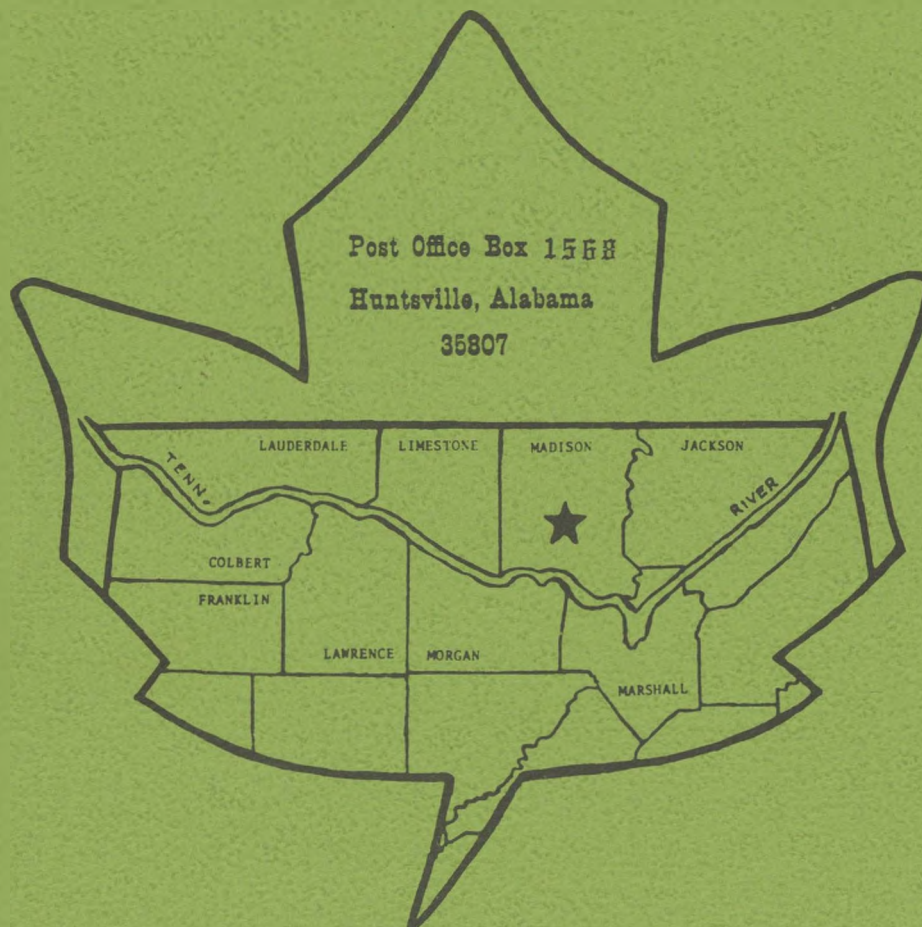

TENNESSEE VALLEY GENEALOGICAL SOCIETY, INC.

Quarterly

Volume 16, Number 3

March 1982

VALLEY LEAVES

Covering Tennessee River Valley Counties of North Alabama

Published

September (No. 1), December (No. 2), March (No. 3), and June (No. 4)

SOLD BY COMPLETE VOLUMES ONLY.

PRICE LIST

Volume 1 (1966-67)	Complete volume, 100 pages plus surname index.....	\$5.00
Volume 2 (1967-68)	Complete volume, 115 pages plus surname index.....	\$5.00
Volume 3 (1968-69)	Complete volume, 120 pages plus surname index.....	\$5.00
Volume 4 (1969-70)	Complete volume.....	\$10.00
	No. 1 and No. 3, 63 pages plus surname index	
	No. 2, Special Edition commemorating Alabama's 150th Anniversary (all Madison County), 100 pages plus full name index	
	No. 4, 1810-15 Tax Lists of Madison County, 64 pages (alphabetical)	
Volume 5 (1970-71)	Complete volume, 180 pages plus full name index.....	\$10.00
Volume 6 (1971-72)	Complete volume, 200 pages plus full name index.....	\$10.00
Volume 7 (1972-73)	Complete volume, 200 pages plus full name index.....	\$10.00
Volume 8 (1973-74)	Complete volume, 200 pages plus full name index.....	\$10.00
Volume 9 (1974-75)	Complete volume, 200 pages plus full name index.....	\$10.00
Volume 10 (1975-76)	Complete volume, 200 pages plus full name index.....	\$10.00
Volume 11 (1976-77)	Complete volume, 200 pages plus full name index.....	\$10.00
Volume 12 (1977-78)	Complete volume, 200 pages plus full name index.....	\$10.00
Volume 13 (1978-79)	Complete volume, 200 pages plus full name index.....	\$10.00
Volume 14 (1979-80)	Complete volume, 200 pages plus full name index.....	\$10.00
Volume 15 (1980-81)	Complete volume, 200 pages plus full name index.....	\$10.00
Volume 16 (1981-82)	Current volume, 200 pages plus full name index, mailed quarterly, included in current membership dues.....	\$10.00

ANCESTOR CHARTS

Volume 1 (March 1975),	160 five-generation charts, indexed.....	\$5.50
Volume 2 (March 1978),	153 five-generation charts, indexed.....	\$6.50
Volume 3 (January 1979),	153 pages of charts, indexed.....	\$6.50

MAP

Map of Revolutionary War Patriots buried in Madison County, Alabama (1976). \$1.00

CENSUS

Lawrence County, Alabama, 1820 State Census, 42 pages, indexed (1978)
TVGS Members..... \$3.00; Non-members..... \$5.00

MEMBERSHIP DUES: \$10.00

The Tennessee Valley Genealogical Society, Inc.
P. O. Box 1568
Huntsville, Alabama 35807

Valley Leaves

Published by the

Table of Contents

Tennessee Valley Genealogical Society, Inc.

Post Office Box 1568

Huntsville, Alabama 35807

Volume 15, Number 3, March 1982

Editor's Page	vi
Bessie King Russell	
Milo B. Howard, Jr.	
Seminar in Genealogy	
Microfilm for the Huntsville Heritage Room	
Constitution Hall Park	
Another Class in Genealogy for Beginners	
NORTH ALABAMA	
DECATUR COUNTY (Created 1821, abolished 1825)	
Decatur County Township Plats, Part III	101
CIVIL WAR PENSIONERS OF NORTH ALABAMA, 1898-1899	
Marshall County, 1898	105
Morgan County, 1898	107
FOR SALE IN WINCHESTER, TENNESSEE	108
COLBERT-FRANKLIN COUNTIES (Created 1867 and 1818)	
Franklin County Marriage Record 2 (1891-1902), 7th Installment . .	109
JACKSON COUNTY (Created 1819)	
Langston Cemetery, Part I	113
LAUDERDALE COUNTY (Created 1818)	
Will Record A, 1835-1858 (9th Installment)	117
Pope Buys Florence Hotel (1824)	120
LAWRENCE COUNTY (Created 1818)	
Tract Book (11th Installment)	121
LIMESTONE COUNTY (Created 1818)	
Myers Cemetery	125
Gone to Texas: Samuel French	127
Death Notices, 1872	128
Corrected Death Notice Info, 1869	128
MADISON COUNTY (Created 1808 as part of the Mississippi Territory)	
Records of the First Baptist Church, Gurley, 1884-1915 (Part II) .	129
1870 Mortality Schedule	133
Dublin-Gooch Cemetery	138
MARSHALL COUNTY (Created 1836)	
Orphan's Court, 1836-1837 (8th Installment)	139
MORGAN COUNTY (Created 1818)	
Marriage Book A, 1821-1861, Part 3	143
Queries	147
Book Reviews	149, 150



Editor's Leaf

MARCH 1982

BESSIE KING RUSSELL, TVGS charter member, introduced many of us to Huntsville history and to the history of our families. The Bessie K. Russell Branch Library was named in her honor. Mrs. Russell, teacher and librarian, died December 10, 1981 at the age of 86 in Sacramento, California, at the home of her son. She was buried in Maple Hill Cemetery in Huntsville. Bless you, Miss Bessie, for what you have meant to all of us.

MILO B. HOWARD, JR., Director of the Alabama Department of Archives and History, and a native of Montgomery, died November 3, 1981. Mr. Howard was the speaker at the first TVGS workshop shortly after he became Director in January 1967. We all mourn the tragedy of his death at 48.

SEMINAR IN GENEALOGY, Saturday, March 20, 1982, will begin at 8 A.M. at the Huntsville Hilton Inn. Jo White Linn (Mrs. Stahle, Jr.) of Salisbury, NC, will be our speaker. This noted genealogist, author and lecturer will speak on North Carolina and Problem Solving in North Carolina Research. Fee is \$12.50 before March 13, 1982 postmark; \$15.00 after. Lynn Harris (Mrs. Tommy) is chairman of the seminar with other local members assisting her.

MICROFILM FOR THE HUNTSVILLE HERITAGE ROOM becomes more important to us as Federal lending ceases. TVGS is contributing the 1900 U.S. Census Soundex for Alabama to the Heritage Room and encourages individual contributions whenever possible.

CONSTITUTION HALL PARK. Grady Kennedy, TVGS representative to the Alabama Historical Commission, reminds us that Constitution Hall Park in Huntsville will open in late Spring of this year. This historic complex features reconstruction of the building at the site of the first State Constitutional Convention in 1819. The Director/Curator of the Park, Daniel J. Hoisington, is interested in locating descendants of the signers of Alabama's first Constitution. Sounds like old times, doesn't it? I was editor when we were searching for the same folks for Alabama's 150th Anniversary Celebration. A list of the signers can be found on page 120 of Volume 3, Number 4, June 1969, *Valley Leaves*. If you can be of help now, contact Constitution Hall Park, P.O. Box 1819, Huntsville, AL 35807.

ANOTHER CLASS IN GENEALOGY FOR BEGINNERS, sponsored by the Huntsville-Madison County Public Library and TVGS is underway. Lecturers are Roy Cochran, Margaret Cowart, Annewhite Fuller, Margaret Henson, Dot Johnson, Helen McKnight, Bill Page, Rane Pruitt and Ezell Terry. Lecturers and additional counselors, Vonda Dihm and Catherine Gilliam, are assisting a full class of budding genealogists. And there is still a waiting line!

REMINDER:

PLEASE WRITE TVGS AT POST OFFICE BOX 1 5 6 8.



North Alabama



DECATUR COUNTY

The exact location of the Decatur/Jackson County line remains elusive but it was in trying to locate it that negative photostats of the township plats of the Decatur County area were ordered. The public surveys of this land were conducted in 1822 and 1823 but annotations as late as 1888 are included. Located and secured by Catherine Gilliam, this information was transcribed by Dorothy S. Johnson and Margaret M. Cowart. This series began in Valley Leaves Volume 16, Number 1, September 1981.

. PART III

Surveyor's District Northern part, A Fractional Township No. 2, Range No. 2 East. Surveyed in the 4th quarter of 1822 by Benjamin Clements, Deputy Surveyor and signed by Jno. Coffee, Surveyor.

Section 1

Northeast $\frac{1}{4}$ William Baker
 E $\frac{1}{2}$ of NW $\frac{1}{4}$ B. Franks
 W $\frac{1}{2}$ of NW $\frac{1}{4}$ J. Hambrick
 NE $\frac{1}{4}$ of SE $\frac{1}{4}$ W. J. Fugue
 SE $\frac{1}{4}$ of SE $\frac{1}{4}$ J. S. Methorn (Methvin?)
 W $\frac{1}{2}$ of SE $\frac{1}{4}$ J. Clarke
 Southwest $\frac{1}{4}$ Joseph Hambrick

Section 2

NE $\frac{1}{4}$ of NE $\frac{1}{4}$ Donated to State
 SE $\frac{1}{4}$ of NE $\frac{1}{4}$ J. Nowlin
 W $\frac{1}{2}$ of NE $\frac{1}{4}$ G. Hambrick
 N $\frac{1}{2}$ of NW $\frac{1}{4}$ J. P. Reagan
 S $\frac{1}{2}$ of NW $\frac{1}{4}$ P. B. Baily
 Southeast $\frac{1}{4}$ Thomas Baily
 E $\frac{1}{2}$ of SW $\frac{1}{4}$ J. Howard
 W $\frac{1}{2}$ of SW $\frac{1}{4}$ B. Howard

Section 3

Northeast $\frac{1}{4}$ George Guilliams
 E $\frac{1}{2}$ of NW $\frac{1}{4}$ T. McCrary
 W $\frac{1}{2}$ of NW $\frac{1}{4}$ J. Hall
 Southeast $\frac{1}{4}$ Sampson Parker
 E $\frac{1}{2}$ of SW $\frac{1}{4}$ J. S. Methorn (Methvin?)
 W $\frac{1}{2}$ of SW $\frac{1}{4}$ J. Robinson

Section 4 (to Old Cherokee Bdry)

Frac of Northeast $\frac{1}{4}$ J. Siscoe
 Southeast $\frac{1}{4}$ John Robinson
 Frac of Southwest $\frac{1}{4}$ William Jackson

Section 5 (to Old Cherokee Bdry)

Frac of SE $\frac{1}{4}$ of SE $\frac{1}{4}$ William Jackson

Section 8 (to Old Cherokee Bdry)

Frac of Northeast $\frac{1}{4}$ T. Clay
 E $\frac{1}{2}$ of SE $\frac{1}{4}$ J. S. Methorn (Methvin?)
 W $\frac{1}{2}$ of SE $\frac{1}{4}$ D. Mitchell
 Frac of Southwest $\frac{1}{4}$ D. Mitchell

Section 9

E $\frac{1}{2}$ of NE $\frac{1}{4}$ T. Bragg
 W $\frac{1}{2}$ of NE $\frac{1}{4}$ B. Bragg
 Northwest $\frac{1}{4}$ James Powers
 NE $\frac{1}{4}$ of SE $\frac{1}{4}$ T. Brigg
 NW $\frac{1}{4}$ of SE $\frac{1}{4}$ D. Goodner
 SE $\frac{1}{4}$ of SE $\frac{1}{4}$ W. Webster
 SW $\frac{1}{4}$ of SE $\frac{1}{4}$ J. P. Beal
 NE $\frac{1}{4}$ of SW $\frac{1}{4}$ D. Goodner
 NW $\frac{1}{4}$ of SW S. J. Stone
 SE $\frac{1}{4}$ of SW $\frac{1}{4}$ W. Webster
 SW $\frac{1}{4}$ of SW $\frac{1}{4}$ J. Stone

Section 10

NE $\frac{1}{4}$ of NE $\frac{1}{4}$ Donated to State
 NW $\frac{1}{4}$ of NE $\frac{1}{4}$ J. Webb
 S $\frac{1}{2}$ of NE $\frac{1}{4}$ W. F. Hereford
 Northwest $\frac{1}{4}$ Jacob Miller
 E $\frac{1}{2}$ of SE $\frac{1}{4}$ I? Cast
 NW $\frac{1}{4}$ of SE $\frac{1}{4}$ E. B. Norris
 SW $\frac{1}{4}$ of SE $\frac{1}{4}$ W. Bragg
 NE $\frac{1}{4}$ of SW $\frac{1}{4}$ E. B. Norris
 NW $\frac{1}{4}$ of SW $\frac{1}{4}$ W. Bragg
 SE $\frac{1}{4}$ of SW $\frac{1}{4}$ W. Y. Massengale
 SW $\frac{1}{4}$ of SW $\frac{1}{4}$ J. Rice

Section 11

N $\frac{1}{2}$ of NE $\frac{1}{4}$ Green Hambrick
 S $\frac{1}{2}$ of NE $\frac{1}{4}$ Samuel Cast
 E $\frac{1}{2}$ of NW $\frac{1}{4}$ J. Campbell
 W $\frac{1}{2}$ of NW $\frac{1}{4}$ J. Hambrick
 N $\frac{1}{2}$ of SE $\frac{1}{4}$ D. S. Province
 S $\frac{1}{2}$ of SE $\frac{1}{4}$ Levi Methrin
 E $\frac{1}{2}$ of SW $\frac{1}{4}$ M. Harper
 W $\frac{1}{2}$ of SW $\frac{1}{4}$ Mary Cast

Section 12

E $\frac{1}{2}$ of NE $\frac{1}{4}$ E. Woodward
 NW $\frac{1}{4}$ of NE $\frac{1}{4}$ B. Franks
 SW $\frac{1}{4}$ of NE $\frac{1}{4}$ W. W. Crayton
 Northeast $\frac{1}{4}$ H. W. Torry (Young in "Old Land Records of Madison Co.")
 E $\frac{1}{2}$ of SE $\frac{1}{4}$ W. W. Crayton
 W $\frac{1}{2}$ of SE $\frac{1}{4}$ J. Hambrick
 NE $\frac{1}{4}$ of SW $\frac{1}{4}$ W. W. Crayton
 SE $\frac{1}{4}$ of SW $\frac{1}{4}$ J. R. Nance
 W $\frac{1}{2}$ of SW $\frac{1}{4}$ A. Hambrick

(-continued-)

Decatur County (continued)

Township 2, Range 2 East

Section 13

E $\frac{1}{2}$ of NE $\frac{1}{4}$ Jackson L. Walker
 W $\frac{1}{2}$ of NE $\frac{1}{4}$ W. W. Crayton
 Northwest $\frac{1}{4}$ Benj. Hambrick
 E $\frac{1}{2}$ of SE $\frac{1}{4}$ Jesse T. Powell
 NW $\frac{1}{4}$ of SE $\frac{1}{4}$ Blank
 SW $\frac{1}{4}$ of SE $\frac{1}{4}$ R. Golden
 Southwest $\frac{1}{4}$ Joel Stone

Section 14

E $\frac{1}{2}$ of NE $\frac{1}{4}$ L. Methrin
 W $\frac{1}{2}$ of NE $\frac{1}{4}$ M. Bankhead
 E $\frac{1}{2}$ of NW $\frac{1}{4}$ D. Gray
 W $\frac{1}{2}$ of NW $\frac{1}{4}$ M. Harper
 NE $\frac{1}{4}$ of SE $\frac{1}{4}$ E. Stone
 NW $\frac{1}{4}$ of SE $\frac{1}{4}$ Blank
 SE $\frac{1}{4}$ of SE $\frac{1}{4}$ Blank
 SW $\frac{1}{4}$ of SE $\frac{1}{4}$ Silas Hickman
 N $\frac{1}{2}$ of SW $\frac{1}{4}$ W. Power
 SE $\frac{1}{4}$ of SW $\frac{1}{4}$ Thomas H. Giles
 SW $\frac{1}{4}$ of SW $\frac{1}{4}$ A. Winn

Section 15

N $\frac{1}{2}$ of NE $\frac{1}{4}$ W. Ellison
 S $\frac{1}{2}$ of NE $\frac{1}{4}$ Wm. W. Wright
 E $\frac{1}{2}$ of NW $\frac{1}{4}$ W. Ellison
 W $\frac{1}{2}$ of NW $\frac{1}{4}$ I. Winkle
 E $\frac{1}{2}$ of SE $\frac{1}{4}$ L. Bragg
 W $\frac{1}{2}$ of SE $\frac{1}{4}$ T. Bragg
 E $\frac{1}{2}$ of SW $\frac{1}{4}$ T. Bragg
 W $\frac{1}{2}$ of SW $\frac{1}{4}$ J. Bragg

Section 16 (School Land)Section 17 (to Old Cherokee Bdry)

E $\frac{1}{2}$ of NE $\frac{1}{4}$ Jas. Rice (Joseph in OLRM)
 W $\frac{1}{2}$ of NE $\frac{1}{4}$ William Young
 Northwest $\frac{1}{4}$ William Young
 E $\frac{1}{2}$ of SE $\frac{1}{4}$ Donated to State
 W $\frac{1}{2}$ of SE $\frac{1}{4}$ J. Rice
 Southwest $\frac{1}{4}$ Edmon Young

Section 20 (to Old Cherokee Bdry)

N $\frac{1}{2}$ of NE $\frac{1}{4}$ J. W. Lanford
 S $\frac{1}{2}$ of NE $\frac{1}{4}$ R. Rodgers
 Northwest $\frac{1}{4}$ King Jinkins
 Southeast $\frac{1}{4}$ Andrew J. Fowler
 Southwest $\frac{1}{4}$ Sarah Wells

Section 21

E $\frac{1}{2}$ of NE $\frac{1}{4}$ Wm. Wells
 NW $\frac{1}{4}$ of NE $\frac{1}{4}$ M. Fanning
 SW $\frac{1}{4}$ of NE $\frac{1}{4}$ W. Jenkins
 NE $\frac{1}{4}$ of NW $\frac{1}{4}$ W. Blackburn
 SE $\frac{1}{4}$ of NW $\frac{1}{4}$ M. Fanning
 W $\frac{1}{2}$ of NW $\frac{1}{4}$ J. Bayless
 E $\frac{1}{2}$ of SE $\frac{1}{4}$ T. A. Pattillo

W $\frac{1}{2}$ of SE $\frac{1}{4}$

S. Cruse

NE $\frac{1}{4}$ of SW $\frac{1}{4}$

W. C. Brag

SE $\frac{1}{4}$ of SW $\frac{1}{4}$

R. Hall

W $\frac{1}{2}$ of SW $\frac{1}{4}$

J. Robertson

Section 22N $\frac{1}{2}$ of NE $\frac{1}{4}$

Alexander Winn

S $\frac{1}{2}$ of NE $\frac{1}{4}$

Wm. Golden

N $\frac{1}{2}$ of NW $\frac{1}{4}$

Thomas Power

S $\frac{1}{2}$ of NW $\frac{1}{4}$

William Wells

Southeast $\frac{1}{4}$

Eldridge Bailes

Southwest $\frac{1}{4}$

William Ellis

Section 23N $\frac{1}{2}$ of NE $\frac{1}{4}$

Silas Hickman

S $\frac{1}{2}$ of NE $\frac{1}{4}$

T. Y. Guthry

E $\frac{1}{2}$ of NW $\frac{1}{4}$

Thomas H. Giles

W $\frac{1}{2}$ of NW $\frac{1}{4}$

J. Bailes

Southeast $\frac{1}{4}$

Thomas H. Giles

NE $\frac{1}{4}$ of SW $\frac{1}{4}$

W. Woodward

SE $\frac{1}{4}$ of SW $\frac{1}{4}$

T. H. Giles

W $\frac{1}{2}$ of SW $\frac{1}{4}$

E. Anthony

Section 24N $\frac{1}{2}$ of NE $\frac{1}{4}$

(unreadable)

SE $\frac{1}{4}$ of NE $\frac{1}{4}$

Geo. S. North

SW $\frac{1}{4}$ of NE $\frac{1}{4}$

N. Bice

NE $\frac{1}{4}$ of NW $\frac{1}{4}$

R. Golden

NW $\frac{1}{4}$ of NW $\frac{1}{4}$

Silas Hickman

S $\frac{1}{2}$ of NW $\frac{1}{4}$

Thomas Y. Guthery

NE $\frac{1}{4}$ of SE $\frac{1}{4}$

Geo. S. North

NW $\frac{1}{4}$ of SE $\frac{1}{4}$

N. Bice

SE $\frac{1}{4}$ of SE $\frac{1}{4}$

Blank

SW $\frac{1}{4}$ of SE $\frac{1}{4}$

J. N. Golden

N $\frac{1}{2}$ of SW $\frac{1}{4}$

Thomas Y. Guthery

SE $\frac{1}{4}$ of SW $\frac{1}{4}$

J. N. Golden

SW $\frac{1}{4}$ of SW $\frac{1}{4}$

Blank

Section 25NE $\frac{1}{4}$ of NE $\frac{1}{4}$

Blank

NW $\frac{1}{4}$ of NE $\frac{1}{4}$

John W. Pilant

S $\frac{1}{2}$ of NE $\frac{1}{4}$

Blank

NE $\frac{1}{4}$ of NW $\frac{1}{4}$

John W. Pilant

SE $\frac{1}{4}$ of NW $\frac{1}{4}$

Blank

W $\frac{1}{2}$ of NW $\frac{1}{4}$

T. M. Irby

Southeast $\frac{1}{4}$

Blank

N $\frac{1}{2}$ of SW $\frac{1}{4}$

Blank

SE $\frac{1}{4}$ of SW $\frac{1}{4}$

W? Sharp

SW $\frac{1}{4}$ of SW $\frac{1}{4}$

Blank

Section 26NE $\frac{1}{4}$ of NE $\frac{1}{4}$

F. M. Spelts

SE $\frac{1}{4}$ of NE $\frac{1}{4}$

Ed Holmes

W $\frac{1}{2}$ of NE $\frac{1}{4}$

Alex Holmes

N $\frac{1}{2}$ of NW $\frac{1}{4}$

G. W. Jones

SE $\frac{1}{4}$ of NW $\frac{1}{4}$

C. Hickman

SW $\frac{1}{4}$ of NW $\frac{1}{4}$

W. A. Cochran

N $\frac{1}{2}$ of SE $\frac{1}{4}$

Alex Holmes

(-continued-)

Decatur County (continued)

Township 2, Range 2 East

Section 26 (continued)

SE $\frac{1}{4}$ of SE $\frac{1}{4}$ Blank
 SW $\frac{1}{4}$ of SE $\frac{1}{4}$ G. W. Jones
 NE $\frac{1}{4}$ of SW $\frac{1}{4}$ C. Hickman
 NW $\frac{1}{4}$ of SW $\frac{1}{4}$ G. W. Jones
 S $\frac{1}{2}$ of SW $\frac{1}{4}$ C. Hickman

Section 27

Northeast $\frac{1}{4}$ John Wells
 E $\frac{1}{2}$ of NW $\frac{1}{4}$ A. Winn
 W $\frac{1}{2}$ of NW $\frac{1}{4}$ P. B. Baily
 E $\frac{1}{2}$ of SE $\frac{1}{4}$ J. Green
 W $\frac{1}{2}$ of SE $\frac{1}{4}$ T. Bragg
 E $\frac{1}{2}$ of SW $\frac{1}{4}$ J. Hall
 W $\frac{1}{2}$ of SW $\frac{1}{4}$ A. Harper

Section 28

Northeast $\frac{1}{4}$ Robert Hall
 E $\frac{1}{2}$ of NW $\frac{1}{4}$ B. Felton
 W $\frac{1}{2}$ of NW $\frac{1}{4}$ B. Fowler
 N $\frac{1}{2}$ of SE $\frac{1}{4}$ Jno. Hall
 S $\frac{1}{2}$ of SE $\frac{1}{4}$ James Robinson
 E $\frac{1}{2}$ of SW $\frac{1}{4}$ J. Milan
 W $\frac{1}{2}$ of SW $\frac{1}{4}$ D. Taylor

Section 29 (to Old Cherokee Bdry)

Northeast $\frac{1}{4}$ David Bell
 E $\frac{1}{2}$ of NW $\frac{1}{4}$ Jno. Randolph
 W $\frac{1}{2}$ of NW $\frac{1}{4}$ Wm. Daughtery
 NE $\frac{1}{4}$ of SE $\frac{1}{4}$ James Bell
 SE $\frac{1}{4}$ of SE $\frac{1}{4}$ N. M. Burdine
 pt of W $\frac{1}{2}$ of SE $\frac{1}{4}$ N. M. Burdine
 pt of NE $\frac{1}{4}$ of SW $\frac{1}{4}$ Jno. Randolph
 pt of NE $\frac{1}{4}$ of SW $\frac{1}{4}$ Wm. Daughtery

Section 30

small frac in NE corner to Old Cherokee Bdry Wm. Daughtery

Section 32 (to Old Cherokee Bdry)

pt of NE $\frac{1}{4}$ of NE $\frac{1}{4}$ Daniel Owens
 SE $\frac{1}{4}$ of NE $\frac{1}{4}$ John S. Berry
 pt of W $\frac{1}{2}$ of NE $\frac{1}{4}$ R. Johnson
 E $\frac{1}{2}$ of SE $\frac{1}{4}$ John S. Berry
 pt of W $\frac{1}{2}$ of SE $\frac{1}{4}$ S. J. House

Section 33

E $\frac{1}{2}$ of NE $\frac{1}{4}$ Jas. Robinson
 W $\frac{1}{2}$ of NE $\frac{1}{4}$ B. F. Ricketts
 NE $\frac{1}{4}$ of NW $\frac{1}{4}$ Blank
 NW $\frac{1}{4}$ of NW $\frac{1}{4}$ J. T. Burdine
 SE $\frac{1}{4}$ of NW $\frac{1}{4}$ J. B. Fitz
 SW $\frac{1}{4}$ of NW $\frac{1}{4}$ John S. Berry
 Southeast $\frac{1}{4}$ Jas. Cochran
 N $\frac{1}{2}$ of SW $\frac{1}{4}$ Geo. Rogers
 S $\frac{1}{2}$ of SW $\frac{1}{4}$ D. Owen

Section 34

E $\frac{1}{2}$ of NE $\frac{1}{4}$ J. Green
 W $\frac{1}{2}$ of NE $\frac{1}{4}$ W. H. Glascock
 Northwest $\frac{1}{4}$ I. Culves (Culver?)
 E $\frac{1}{2}$ of SE $\frac{1}{4}$ G. Howard
 W $\frac{1}{2}$ of SE $\frac{1}{4}$ J. W. Irby
 Southeast $\frac{1}{4}$ Abraham Miller

Section 35

NE $\frac{1}{4}$ of NE $\frac{1}{4}$ J. Gwathney
 NW $\frac{1}{4}$ of NE $\frac{1}{4}$ J. L. Criner
 SE $\frac{1}{4}$ of NE $\frac{1}{4}$ Blank? or J. Gwathney?
 SW $\frac{1}{4}$ of NE $\frac{1}{4}$ J. C. Moore
 E $\frac{1}{2}$ of NW $\frac{1}{4}$ G. Howard
 W $\frac{1}{2}$ of NW $\frac{1}{4}$ W. F. Scott
 E $\frac{1}{2}$ of SE $\frac{1}{4}$ Blank?
 W $\frac{1}{2}$ of SE $\frac{1}{4}$ H. C. Scott
 Southwest $\frac{1}{4}$ James C. Moore

Section 36

Northeast $\frac{1}{4}$ William Sharp
 N $\frac{1}{2}$ of NW $\frac{1}{4}$ William Sharp
 SE $\frac{1}{4}$ of NW $\frac{1}{4}$ William Sharp
 SW $\frac{1}{4}$ of NW $\frac{1}{4}$ Blank
 E $\frac{1}{2}$ of SE $\frac{1}{4}$ Lee Roy Sharp
 W $\frac{1}{2}$ of SE $\frac{1}{4}$ G. Sharp
 E $\frac{1}{2}$ of SW $\frac{1}{4}$ P. Sharp
 W $\frac{1}{2}$ of SW $\frac{1}{4}$ Blank

Surveyor's District Northern part, A Fractional Township No. 3, Range No. 2 East. Surveyed in the 4th quarter of 1822 by Benjamin Clements, Deputy Surveyor and signed by Jno. Coffee, Surveyor. (All east of Old Cherokee Boundary Line.)

Section 1

NE $\frac{1}{4}$ of NE $\frac{1}{4}$ S. Sharp
 SE $\frac{1}{4}$ of NE $\frac{1}{4}$ J. Pence
 W $\frac{1}{2}$ of NE $\frac{1}{4}$ Jno. Sharp
 E $\frac{1}{2}$ of NW $\frac{1}{4}$ Leroy Sharp
 W $\frac{1}{2}$ of NW $\frac{1}{4}$ Sanbours? B. KeyKendall
 NE $\frac{1}{4}$ of SE $\frac{1}{4}$ W. H. Sharp
 SE $\frac{1}{4}$ of SE $\frac{1}{4}$ J. Sharp
 W $\frac{1}{2}$ of SE $\frac{1}{4}$ J. Sharp
 Southwest $\frac{1}{4}$ pt in Challenge Reservation
 pt to J. Calhoun

Section 2

N $\frac{1}{2}$ of NE $\frac{1}{4}$ W. M. Griffin
 S $\frac{1}{2}$ of NE $\frac{1}{4}$ Jos. Sharp
 E $\frac{1}{2}$ of NW $\frac{1}{4}$ H. C? Scott
 W $\frac{1}{2}$ of NW $\frac{1}{4}$ D. Taylor
 Southeast $\frac{1}{4}$ pt in Challenge Reservation
 pt to Jos. Sharp
 (-continued-)

Decatur County (continued)

Township 3, Range 2 East

Section 2 (continued)

Southwest $\frac{1}{4}$ pt to Challenge Res.
 pt to J. E. Taylor

Section 3

Entire Section Giles McNulty's Reser-
 vation except pt of North-
 east $\frac{1}{4}$ to J. Kirksey and
 pt of Southeast $\frac{1}{4}$ to C. R.
 Eaton

Section 4

Northeast $\frac{1}{4}$ Giles McNulty's Res.
 pt of E $\frac{1}{2}$ of NE $\frac{1}{4}$ A. Cochran
 E $\frac{1}{2}$ of NW $\frac{1}{4}$ A. Cochran
 W $\frac{1}{2}$ of NW $\frac{1}{4}$ W. Rogers
 Southeast $\frac{1}{4}$ pt of Giles McNulty's
 Reservation & pt of Thom-
 as Wilson's Reservation &
 pt to J. McCartney
 N $\frac{1}{2}$ of SW $\frac{1}{4}$ J. Bell
 S $\frac{1}{2}$ of SW $\frac{1}{4}$ J. McCartney

Section 5

pt of Northeast $\frac{1}{4}$ J. House
 pt of Southeast $\frac{1}{4}$ H. Stakes

Section 9

Entire Section Thomas Wilson's Res-
 ervation except pt of
 NW $\frac{1}{4}$ of NE $\frac{1}{4}$ and pt of NE $\frac{1}{4}$
 of NW $\frac{1}{4}$ to J. McCartney

Section 10

Entire Section Thomas Wilson's Res-
 ervation except pt of
 Northeast $\frac{1}{4}$ and pt of
 Southeast $\frac{1}{4}$ to Gallanus
 Winn

Section 11

Northeast $\frac{1}{4}$ Challenge's Reservation
 Northwest $\frac{1}{4}$ Challenge's Reservation
 except pt of E $\frac{1}{2}$ of NW $\frac{1}{4}$ &
 all of W $\frac{1}{2}$ of NW $\frac{1}{4}$ to Sml.
 Grigsby
 pt of N $\frac{1}{2}$ of SE $\frac{1}{4}$ Challenge's Res.
 pt of N $\frac{1}{2}$ of SE $\frac{1}{4}$ Chas. Robinson
 S $\frac{1}{2}$ of SE $\frac{1}{4}$ Chas. Robinson
 pt of NE $\frac{1}{4}$ of SW $\frac{1}{4}$ Challenge's Res.
 pt of NE $\frac{1}{4}$ of SW $\frac{1}{4}$ Geo. J. Weaver
 NW $\frac{1}{4}$ of SW $\frac{1}{4}$ Jn? Turner?
 S $\frac{1}{2}$ of SW $\frac{1}{4}$ Geo. J. Weaver

Section 12

E $\frac{1}{2}$ of NE $\frac{1}{4}$ Blank
 W $\frac{1}{2}$ of NE $\frac{1}{4}$ Jos. Sharp

pt of E $\frac{1}{2}$ of NW $\frac{1}{4}$ Jos. Sharp
 pt of E $\frac{1}{2}$ of NW $\frac{1}{4}$ Challenge's Res.
 NE $\frac{1}{4}$ of SE $\frac{1}{4}$ Thos. Fearn
 NW $\frac{1}{4}$ of SE $\frac{1}{4}$ R. McAnulty
 SE $\frac{1}{4}$ of SE $\frac{1}{4}$ Blank
 SW $\frac{1}{4}$ of SE $\frac{1}{4}$ S. Brown
 Southwest $\frac{1}{4}$ R. McAnulty except pt of
 NW $\frac{1}{4}$ of SW $\frac{1}{4}$ to Challenge's
 Reservation

Section 13

N $\frac{1}{2}$ of NE $\frac{1}{4}$ A. F. Eledge
 SE $\frac{1}{4}$ of NE $\frac{1}{4}$ G. Brown
 SW $\frac{1}{4}$ of NE $\frac{1}{4}$ A. F. Eledge
 NE $\frac{1}{4}$ of NW $\frac{1}{4}$ Blank
 NW $\frac{1}{4}$ of NW $\frac{1}{4}$ Wm. Pence
 SE $\frac{1}{4}$ of NW $\frac{1}{4}$ A. F. Eledge
 SW $\frac{1}{4}$ of NW $\frac{1}{4}$ Blank
 N $\frac{1}{2}$ of SE $\frac{1}{4}$ G. Brown
 S $\frac{1}{2}$ of SE $\frac{1}{4}$ Ezekiel Beane (or Beam?)
 E $\frac{1}{2}$ of SW $\frac{1}{4}$ Frederick Ice
 NW $\frac{1}{4}$ of SW $\frac{1}{4}$ F. Ice
 SW $\frac{1}{4}$ of SW $\frac{1}{4}$ C. B. Derrick

Section 14

NE $\frac{1}{4}$ of NE $\frac{1}{4}$ Wm. Pence
 SE $\frac{1}{4}$ of NE $\frac{1}{4}$ Blank
 W $\frac{1}{2}$ of NE $\frac{1}{4}$ Heirs of James? C. Fowlkes,
 dec'd
 E $\frac{1}{2}$ of NW $\frac{1}{4}$ Heirs of James? C. Fowlkes,
 dec'd
 NW $\frac{1}{4}$ of NW $\frac{1}{4}$ W. H. Fowler
 SW $\frac{1}{4}$ of NW $\frac{1}{4}$ W. Roundtree
 Southeast $\frac{1}{4}$ Blank
 NE $\frac{1}{4}$ of SW $\frac{1}{4}$ Blank
 NW $\frac{1}{4}$ of SW $\frac{1}{4}$ W. Roundtree
 S $\frac{1}{2}$ of SW $\frac{1}{4}$ Blank

Section 15

Northeast $\frac{1}{4}$ Levi Vail except pt of NW $\frac{1}{4}$
 of NE $\frac{1}{4}$ in Thomas Wilson's
 Reservation
 Northwest $\frac{1}{4}$ Sam'l Tipton except small
 pt in NE $\frac{1}{4}$ of NW $\frac{1}{4}$ in Thomas
 Wilson's Reservation
 E $\frac{1}{2}$ of SE $\frac{1}{4}$ J. F. Culp
 W $\frac{1}{2}$ of SE $\frac{1}{4}$ Jno. Tipton
 pt of Southwest $\frac{1}{4}$ D. Parker

Section 22

small pt of Northeast $\frac{1}{4}$ W. Burton, Sr.?

(-continued in next issue-)



CIVIL WAR PENSIONERS
OF NORTH ALABAMA
1898 - 1899

The following names of Civil War pensioners, including widows drawing a pension, were copied from a ledger in the Military Records Division of the Alabama Department of Archives and History in Montgomery, Alabama. The ledger is entitled "S. T. Soldiers Record, 2, Treasurers Office, Alabama, 1898-1899."

See introduction in the December 1981 issue of Valley Leaves, Volume 16, Number 2, for more detailed information and for listings of Colbert, Franklin, Jackson, Lauderdale, Lawrence, Limestone and Madison Counties. This information was contributed by Dorothy Scott Johnson, Huntsville, Alabama.

MARSHALL CO. 1898

Allen, L. B.	Edmonson, Mark	Ledbetter, R. H.
Arnett, G. F.	Eudy[?], Levi	Law, William M.
Barley, W. H.	Evans, Alfred T.	Maddera, James T.
Barnes, Berry	Farr, David N.	Maddera, William A.
Baxter, S. B.	Farmer, Morton	Maroney, Walter
Bearden, O[?] B.	Fletcher, J. M.	Merritt, P. D.
Bell, W. M.	Freeman, Joseph A.	Miller, Geo. W.
Bright, Reuben C.	Foster, W. M.	Miller, N. E.
Bodine, Frank	Floyd, James	Mims, L. C.
Bolton, R. W.	Gaines, C. P.	Morgan, Jno. L.
Bonds, T. J.	Garner, J. W.	McGriff, T. C.
Buckelew, J. W.	Garrison, J. F.	McKinney, James A.
Burroughs, Geo. W.	Grammer, J. R.	Nelms, T. L.
Bryant, Charles	Glass, William	Nelson, A. S.
Camp, W. C.	Gregory, J. T.	Nixon, J. B.
Cartee, T. S.	Gilley, W. B.	Paseur, C.
Carter, N. J.	Griffin, Thos. D.	Patterson, G. W.
Clark, J. C.	Gorham, Harry M.	Phillips, L.
Craig, William	Gross, Jonathan	Rainwater, M. P.
Crawford, L. M.	Hales, N. R.	Reese, Henry
Coleman, James A.	Hamil, I. N.	Reynolds, William
Collins, C. C.	Hardin, F. M.	Rigsby, S. J.
Corley, P. J.	Hays, G. F.	Rigsby, J. W.
Corn, S. A.	Helms, F. M.	Roden, W. D[?]
Cowen, J. E.	Hendrix, W. M.	Raaks[?], R.
Cox, Arthur B.	Hill, M. K.	Ruth, J. A.
Culpepper, Robert J.	House, S.	Sampson, J. C.
Curry, W. W.	Hulsey, William	Sherey, Newman
Cruse, Jeff	Hudgins, L. Z.	Slaton, W. P.
Daniel, George T.	Jackson, Wm.	Sparks, T.
Davis, John S.	Johnston, Jas. L.	Strange, W. B.
Davidson, Hiram	Jones, A. J.	Selvidge, J. M.
Derrick, N. H.	Kelm, W. A.	Spear, E. G.
Doss, W. B.	Knight, Jesse	Stewart, W. M.
Dunkin, J. R.	Landers, G. M.	Stewart, J. H.
Duram, S. H.	Lang, H. W.	Smith, A.
	Law, R. C.	Solley, J. M.
	Lee, E. B.	Stone, Isaac

(-continued-)

Civil War Pensioners of North Alabama, 1898-99, continued

Marshall County 1898 (cont)

Scott, Calvin
 Taylor, W. H.
 Thomason, Geo.
 Tucker, William
 Upton, W. B.
 Vines, J. K.
 Walden, James
 Walker, J. W.
 Walls, Wm. B.
 Ward, Walter H.
 Watts, James
 Watson, W. N.
 Way, B. F.
 Wheeler, John W.
 Wiggins, L. M.
 Williams, J. M.
 Wilson, S. F.
 Winfrey, James M.
 Winkles, William
 Whitehead, Wm. G.
 Young, Jesse

 Abercrombie, Mrs. Lucinda
 Adams, Mrs. M. M.
 Adams, Mrs. Rutha M.
 Bean, Mrs. Eliza A.
 Berry, Mrs. Mary H.
 Bevill, Mrs. Mary
 Bain, Mrs. Louisa
 Baird, Mrs. Mary
 Bradley, Mrs. E. E.
 Brannon, Mrs. Sarah A.
 Bodine, Mrs. Margaret B.
 Bolinger, Mrs. M. A.
 Brown, Mrs. Mary A.
 Buchanan, Mrs. Mary
 Butler, Mrs. Nancy Adaline
 Camp, Mrs. Susan
 Campbell, Mrs. Nancy A.
 Cardwell, Mrs. S. J.
 Clay, Mrs. Celina
 Davis, Mrs. Martha J.
 Derrick, Melinda A.
 Dyer, Mrs. Susan
 Edins, Mrs. Nora
 Endy, Mrs. Lucinda Jane
 Franklin, Mrs. Melvina
 Fowler, Mrs. Martha M.

Gantrey, Mrs. Eliza M.
 Godsey, Mrs. Polly
 Hardin, Mrs. Lavina
 Harris, Mrs. Francis E.
 Haynes, Mrs. Evaline
 Hughes, Mrs. Elizabeth
 Jackson, Mrs. Sarah A.
 Jett, Mrs. M. E.
 Johnson, Mrs. E. L.
 Johnson, Mrs. Lizabeth
 Kelly, Mrs. Martha Ann
 King, Mrs. Phonora
 King, Mrs. Elizabeth
 Ledbetter, Mrs. Sarah
 Lett, Mrs. Anna G.
 Leverett, Mrs. Martha E.
 Lewis, Mrs. Mary
 Machen, Mrs. S. A.
 Mayer, Mrs. Mary
 Morris, Mrs. Charlotte
 McCay, Mrs. Mary
 McClendon, Mrs. Martha R.
 McGlaughn, Mrs. Nancy J.
 McKinney, Mrs. Sallie
 Nelson, Mrs. Emily
 Pendleton, Mrs. Nancy D.
 Peters, Mrs. Lydia
 Pool, Mrs. Jane
 Reynolds, Mrs. Arttisa
 Rivers, Mrs. Mary E.
 Roden, Mrs. Charlotte
 Rutledge, Mrs. Jane
 Selvedge, Mrs. Sarah J.
 Sims, Mrs. Katie O.
 Smith, Mrs. Permelia
 Spitzer, Mrs. Mary
 Snow, Mrs. Francis
 Stone, Mrs. Lucinda
 Sewards, Mrs. Harriet R.
 Taylor, Mrs. Mary A.
 Thackston, Mrs. C. A.
 Thomas, Mrs. Emelina Y.
 Thompson, Mrs. C. M.
 Tyler, Mrs. Isabella
 Vaughn, Mrs. Sarah
 Walker, Mrs. Minervia Jane
 Walker, Mrs. Elizabeth
 Walker, Mrs. Nancy J.
 Webb, Mrs. Anner A.

(-continued-)

Civil War Pensioners of North Alabama, 1898-99, continued

Marshall County 1898 (cont)

Weeks, Mrs. Margaret
 Wilkerson, Mrs. Marthina
 Williams, Mrs. Mary
 Willingham, Mrs. Mary Jane
 Winkles, Mrs. Rachel

MORGAN COUNTY, 1898

Acker, S.
 Allen, John J.
 Ausley, J. E.
 Bradley, Abner
 Bibb, J. S.
 Black, J. M. Jr.
 Breeding, James
 Breedlove, D. D.
 Briscoe, P. R.
 Brown, W. M.
 Brown, Lewis Martin
 Brown, W. D.
 Callahan, Wm.
 Chapprell, J. W.
 Clark, J. W.
 Clark, D. W.
 Clayton, W. W.
 Conley, B. S.
 Crow, W. S.
 Day, A. J.
 Delender, L. B.
 Densmore, S. P.
 Echols, Elijah
 Echols, Joseph
 Edwards, David L.
 Flin, P. C.
 Furgeson, M. H.
 Fuller, J. S.
 Gray, W. F.
 Halbrooks, J. L.
 Holmes, W. M.
 Hawk, J. E.
 Henderson, John
 Henson, John
 Higdon, Chas.
 Holt, S. H.
 Howell, S. G.
 Howell, J. S.
 Howell, H. L.
 Hudson, C. H.

Hubbard, J. J.
 Johnson, R. H.
 Johnson, F. B.
 Johnson, W. H.
 Jolly, W. M.
 Key, Martin
 Kilpatrick, J. A.
 King, C. K.
 Kirby, J. T.
 Kirby, W. J.
 Lake, Wm. F.
 Lane, J. A.
 Latham, G. W.
 Livingston, W. R.
 Lott, John J.
 Love, J. C.
 Lukes, James F.
 Lynn, D. T.
 Martin, John
 Moore, D. M.
 Morrow, S. A.
 Mullican, W. J.
 McCutchen, J. M.
 Newby, J. M.
 Nobles, S. S.
 Nunn, E. T.
 Oliver, J. D.
 Pannel, J. L.
 Parker, W. S.
 Pastell, Phillip
 Poteet, Theophila
 Plemmons, Jno. L.
 Ramsey, J. B.
 Reynolds, Stark
 Richards, T. H.
 Rose, Isaiah
 Roper, Jason
 Rogers, J. R.
 Roger, G. W.
 Ryan, T. C.
 Russell, W. J.
 Sarton[Sartor?], A. J.
 Stewart, A. Y.
 Sparkman, A. B.
 Stephens, O. T.
 Shirley, G. F.
 Smith, G. R.
 Smith, J. D.

Stockton, A. M.
 Thomas J. S.
 Thompson, W. D.
 Turner, W. P.
 Turner, H. L.
 Umphrey, M. C.
 Vest, G. W.
 Wade, J. H.
 Ward, William
 Warrick, F. M.
 Wiley, O. J.
 Williams, Joseph
 Williams, J. G.
 Williamson, A. W.
 Wilson, Cullen
 Winton, S. W.
 Whipple, A. B.
 Whisenant, H. D.
 Woods, Green B.
 Woods, H. W.
 Wood, Maniel B.
 Woodall, M. E.
 Woodall, Wm.
 Yeager, Robert H.
 Young, J. H.

Askew, Mrs. B. S.
 Banks, Mrs. M. J.
 Barnes, Mrs. Margaret E.
 Black, Mrs. Elizabeth
 Bradley, Mrs. Annie
 Brown, Mrs. Martha J.
 Craft, Mrs. S. A.
 Craft, Mrs. L. T.
 Dutton, Mrs. M. C.
 Eday, Mrs. Mary
 England, Mrs. W. F.
 Fennell, Mrs. F. S.
 Fulghum, Mrs. M. C.
 Holloway, Mrs. Mary E.
 Howe, Mrs. E. J.
 Kilpatrick, Mrs. H. J.
 Laferer, Mrs. J. H.
 Lamascus, Mrs. Eliza
 Lovelady, Mrs. M. W.
 Lyle, Mrs. A. C.
 Lyle, Mrs. Rebecca W.

(-continued-)

Civil War Pensioners of North Alabama, 1898-99, continued

Morgan County 1898 (cont)

Lemly: see Semly

Martin, Mrs. E. A.

Mullins, Mrs. Smitha

Mynatt, Mrs. M. L.

Oldacre, Mrs. Hannah

Orr, Mrs. Sallie L.

Self, Mrs. E. N. C.

Semly, Mrs. P. C.

Simpson, Mrs. Susan G.

Smith, Mrs. E. M.

Smith, Mrs. Eliza G.

Smith, Mrs. Mary J.

Smith, Mrs. Parale

Summerford, Mrs. Martha

Tapscott, Mrs. Catherine

Vaughn, Mrs. S. E.

Wallace, Mrs. S. N.

Wright, Mrs. M. A.

Wright, Mrs. S. W.

FOR SALE
IN
WINCHESTER, TENNESSEE

Large Tavern known as BELL TAVERN in Winchester, Tennessee-being the house lately occupied by Mr. Bobe and now possessed by Mr. Ward-is for sale. Situated on public square, building partly brick and partly frame, spacious.

The eastern and western stages pass through town 6 times a week and the great road leading from Knoxville to Huntsville, a road greatly traveled, leads through town: the road from Huntsville to Georgia and from Nashville to Georgia also runs through town.

For terms apply to Mrs. Purdom at her residence on the road leading from Winchester to M^lMinville, 21 miles from the former place, etc.

The Nashville Whig, Nashville, Tennessee
26 July 1824, Monday
Page 1, column 3





Colbert - Franklin



FRANKLIN COUNTY
MARRIAGE RECORD NO. 2 (1897-1902)
(Seventh Installment)

These marriages were copied under a Summer Youth Program with this record copied by Thomas Sidney Hyde, Jr., of Russellville, Alabama. Contributed by Mrs. Evelyn B. Evans, this series began in the September 1980 issue of Valley Leaves, Volume 15, Number 1.

PAGE	GROOM	BRIDE	DATE	OFFICIAL
290	Roberson, James F. (c)	Reed, Julia A. (c)	23 Jan 1901	James Hampton
306	Rollins, F.M.	Hall, Manerva	28 Apr 1901	A.L. Anderson
312	Riner, John B.	King, Mary T.	23 Jun 1901	Frank H. Gardner
314	Reaves, S.R.	Moore, Eva	23 Jun 1901	B.H. James
346	Robinson, P.C.	Hamilton, Mary L.	29 Oct 1901	James Hampton MG
352	Rice, W.L.	Swinney, Mary	24 Nov 1901	W.N. Taylor MG
353	Rogers, Ed. O.	Vinson, Anna	26 Nov 1901	J.D. Thorn MG
357	Russell, S.L.	James, Leathie L.	8 Dec 1901	T.E. James
372	Roberson, Thomas H.	Keelon, Maggie	8 Jan 1902	A.W. Briscoe
404	Rogers, Riley G.	King, Lula	1 Jun 1902	T.E. McCulloch
3	Summerel, William T.	Grissom, Mary F.	15 Jul 1897	A.R. Smith JP
11	Stanphill, W.R.	Garrison, Anna	12 Sep 1897	J.T. Mink MG
17	Sparks, Isom	Yocum, Amy	24 Oct 1897	John Askew
18	Sanderson, J.C.	Power, Victoria	7 Nov 1897	Bennett White
19	Scott, John	Davis, Elinora	9 Nov 1897	J.F. Smith JP
25	South, Joe L.	Stonecipher, Joan	8 Dec 1897	G.L. Cleere
34	Shewbart, A.A.	Rickard, Sarah L.	12 Jan 1898	B.G. Hardin MG
41	Sockwell, Ed B.	Smith, Mary A.	2 Feb 1898	M.W. Dailey MG
44	Smith, Andrew	Hamilton, Mattie	13 Feb 1898	J.H. Kelley
46	Sibley, Kibbie	Porter, Allie J.	23 Mch 1898	J.L. Brittain
62	Scrugg, Jake	Montgomery, Josie	29 Jun 1898	W.H. Hamilton MG
67	Seay, James A.	Foreman, Belle	31 Jul 1898	Geo.W. Stout JP
69	Slay, J.T.	Franks, Nancy Jane	7 Aug 1898	J.M. Haney

(continued)

Franklin County Marriage Record No. 2, continued

69	Sugg, John	Pillow, Emma	7 Aug 1898	G.W. Stout JP
86	Sims, L.N.	Kennedy, Nettie J.	13 Nov 1898	J.T. Thompson
88	Smith, Jesse H.	Pace, Mary C.	16 Nov 1898	T.F. McCulloch JP
82	Sanders, John E.	Robinson, George Ann	23 Oct 1898	Bennett White JP
83	Stevens, Robert	Wilson, Sallie	6 Aug 1898	G.C. Almon, P.Judge
89	Saint, D.E.	Carlisle, Minnie	17 Nov 1898	J.T. Hurley, MG
104	Strickland, John M.	Love, Josie E.	1 Jan 1899	J.M. Haney
109	Smith, Lonnie (c)	Molwee, Easter (c)	11 Jan 1899	J.B. Fennell MG
113	Smith, James R.	Wright, Bessie	18 Jan 1899	G.W. Stout JP
130	Scott, J.H.	Hardin, Mandy	23 Mch 1899	B.G. Hardin MG
132	Scott, Richard	Bobo, Vonie	13 Apr 1899	R.A. Gardner MG
140	Seale, Arthur W.	Claunch, Martha E.	2 Jul 1899	W.H. Strickland
151	Schandler, Robert	Miller, Catherine	20 Aug 1899	J.D. Thorn
159	Strawbridge, S.H.	Goss, Mattie	8 Oct 1899	Geo W. Sims MG
165	Sandlin, Albert W.	Hamilton, Sallie	29 Oct 1899	W.H. Austin MG
177	Summers, J.J.	Paterson, Tildy E.	3 Dec 1899	J.H. Kimbrough MG
181	Smith, J.M.	Steele, M.C.	17 Dec 1899	A.H. Powell JP
182	Smith, David (c)	Price, Willie (c)	20 Dec 1899	David Harris MG
187	Skidmore, Robert D.	Willis, Cathrine	24 Dec 1899	B.H. James MG
193	Sugg, Henry (c)	Price, Lula (c)	4 Jan 1900	C.J. Nichols MG
198	Stansell, W.W.	Ozbirn, Mary A.	25 Jan 1900	Frank H. Gardner MG
222	Stone, W.J.	Hall, Sallie Henry	13 May 1900	A.J. Barnett NP ex-of JP
227	Stanford, R.J.	Mitchell, Mattie	24 Jun 1900	A.H. Powell JP
242	Spradley, J.M.	Haney, Susie	26 Aug 1900	J.H. Kimbrough
249	Saint, James	Bruton, Emmer	23 Sep 1900	W.I. Thompson JP
271	Spencer, Joseph E.	Garrison, Dicy A.M.	18 Dec 1900	Wm G. Stanphill
274	Stancil, Lonzo J.	Burfield, Mary H.	23 Dec 1900	W.N. Taylor MG
285	Strickland, E.W.	Byrd, Mattie	10 Jan 1901	S.B. Ramsey
287	Spencer, John W.	Upton, Ella S.	17 Jan 1901	Wm G. Stanphill NP ex-of JP (continued)

Franklin County Marriage Record No. 2, continued

288	Strange, James M.	Rauschenburg, Sophia	27 Feb 1901	W.H. Austin	MG
300	Spradlin, Hamsin	Burnett, Rena	5 Mch 1901	Albert W. Briscoe	
308	Shell, William	Reynolds, Cynda	12 May 1901	Walter Hamilton	MG
309	Smith, Arthur W.	Petree, Florence C.	27 May 1901	W.H. Austin	MG
309	Smith, J.T.	Bentley, Martha	2 Jun 1901	W.T. Chambless	MG
317	Simmons, C.	Wells, Annie	2 Jul 1901	J.T. Whitehurst	
340	Sargent, S.D.	Gibson, Annie Lee	16 Oct 1901	R.I. Walston	VDM
354	Sims, S.T.	Self, Jennie	1 Dec 1901	W.O. Vinson	JP
356	Stegall, W.H.	Crowell, Marietta L.P.	1 Dec 1901	Porter Duboise	
364	Scott, J.B.	Duncan, Oder E.	26 Dec 1901	L.M. Bailey	
368	Sugg, W.W.	Glass, Emma I.	1 Jan 1902	W.H. Austin	MG
377	Sullivan, J.M.	Bacon, Laura	19 Jan 1902	Benjamin Avey	MG
384	Sugg, Frank (c)	Tompkins, Mandy (c)	not shown		
390	Swims, William A.	Hill, Texander	23 Feb 1902	W.W. Meherg	
390	Scott, Noble S.	Moore, Lutie	23 Feb 1902	B.H. James	MG
394	Smith, Edward L.	Mansell, Maudie	30 Mch 1902	T.E. McCulloch	
397	Smith, M.N.	Moody, <u>Frank</u> A.	16 Apr 1902	Elder G.B. Wade	
399	Smith, Ed (c)	Davis, Lillie (c)	3 May 1902	C.J. Nichols	MG
402	Stegall, Thomas G.	Cole, Savannah	31 May 1902	J.W. Doss	JP
404	Shedd, George W.	Clark, Octavia	16 Jun 1902	J.W. Clark	
405	Smith, Arthur	Henley, Lucy	15 Jun 1902	J.B. Fennell	
406	Smith, Charley	Key, Bertha	14 Jun 1902	C.J. Nichols	MG
6	Thomason, Hane	Fisher, Elder	15 Aug 1897	W.H. Austin	MG
52	Townsend, J.W.	Johnson, Aminda	8 May 1898	B.G. Hardin	MG
53	Clark, Calvin	Emett, Virginia	not shown		
71	Taylor, J.A.	Malone, Alice C.	21 Aug 1898	J.J. Jones	MG
72	Taylor, L.M.	Handley, Ida	24 Aug 1898	not shown	
94	Thompson, Luther	Smith, Martha	4 Dec 1898	J.M. Haney	
109	Tucker, E.G.	West, Evaline	8 Jan 1899	John W. Doss	JP

(continued)

Franklin County Marriage Record No. 2, continued

112	Tiffin, W.V.	Patterson, Samantha M.	2 Feb 1899	G.W. Sims JP
137	Taylor, Leander	Taylor, Laura Bell	21 May 1899	E.C. White
143	Thompson, Henry	Bean, Bertha	11 Jul 1899	W.H. Hamilton MG
149	Thorn, J.D.	Barksdale, Modena	20 Aug 1899	M.J. Hart
161	Todd, George A.	Sumeral, Eda	8 Oct 1899	A.R. Smith JP
175	Taylor, F.H.	Avery, Nora	3 Dec 1899	R.A. Gowder
204	Truitt, C.J.	Birdyshaw, Lula B.	25 Feb 1900	W.V. Taylor
235	Taylor, John E.	Fowler, Josie	26 Jul 1900	Simon B. Jones
250	Thrasher, Bin	McGee, Paley	23 Sep 1900	M.J. Pace MG
259	Thomeson, C.E.	Camobell, Annie M.	31 Oct 1900	Frank H. Gardner
262	Taylor, John L.	McKinney, Sarah L.	22 Nov 1900	Josiah J. Jones
263	Turnaville, Felix M.	Green, Eliza J.	20 Dec 1900	W.I. Thompson
294	Thompson, L.D.	Chambless, Nancy V.	17 Feb 1901	J.O. Hester
297	Thornton, J.C.	Gibson, Florence Lee	27 Feb 1901	T.E. McCulloch JP
317	Thornton, W.T.	King, Callie L.	1 Jul 1901	Albert W. Briscoe
324	Thomas, Andrew (c)	Hall, Mandy (c)	4 Aug 1901	D.M. Turner
339	Thorn, James S.	Devaney, Effie	27 Sep 1901	B.H. James MG
349	Thompson, J.M.	Posey, Drewnetter N.	14 Nov 1901	J.W. O'Kelley
345	Thompson, T.B.	Meherg, M.F.D.	31 Oct 1901	W.N. Taylor
351	Thorn, John W. Jr.	Devaney, Agnes	17 Nov 1901	B.H. James
353	Taylor, W.F.	Greenhill, Julia	24 Nov 1901	J.O. Hester
382	Thomas, C.T. (c)	Wear, Lula (c)	29 Jan 1902	E.F. James
387	Thompson, Robert	McKernel, Laura	13 Feb 1902	C.J. Nichols
406	Thornton, John J.	Fisher, Aggie L.	21 Jun 1902	R.J. Moody, P.Judge
122	Underwood, William (c)	Sugg, Minnie (c)	16 Feb 1899	David Harris
76	Vess, John J.	Roden, Martha L.	11 Sep 1898	John G. Whittock MG
101	Vaughn, William	Tharp, Jennie	22 Dec 1898	W.C. Summers MG
185	Vandiver, James M.	Ingram, Persie	24 Dec 1899	J.W. Doss JP
319	Vandiver, James M.	Smith, Mandy J.	15 Jul 1901	R.J. Moody, P.Judge

(To be concluded in June 1982 issue)



Jackson

LANGSTON CEMETERY

This large cemetery of almost four hundred graves is located in the SE/4 of the SE/4 of Section 2 Township 7 South, Range 5 East at Langston, Alabama. The cemetery was inventoried by Nancy Cabaniss Parker in 1979 and by Ann Esslinger Cochran and Dorothy Scott Johnson in 1980. This is a compilation of the two inventories. Part I of two parts.

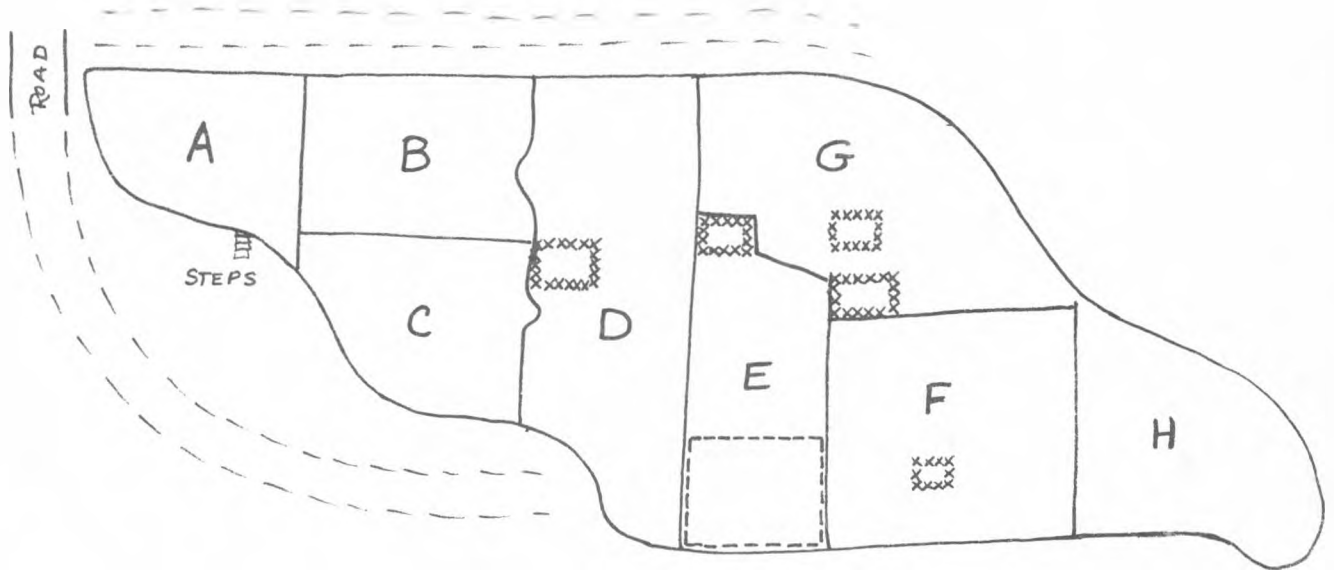

LEGEND: xxxxxx = iron picket fence ----- = brick fence

This map indicates the approximate division of the cemetery for the purpose of recording tombstone inscriptions. Generally, we have begun our recording in the lower left hand corner of each section and moved from bottom to top in rows. Stones are not in perfect rows, many variances occur. Many graves are not marked by inscribed stones.

SECTION "A"

These graves are at the extreme left end of the cemetery:

BASS	
CLENDON	EFFIE
Jan. 18, 1914	May 26, 1917
(blank)	March 1, 1976

(Scottsboro Funeral Home marker:)
JOHNNY B. CALLAHAN
Died July 17, 1980
Aged 59 years.

ROW 1:

BARBARA JEAN
WILBORN
GARRISON
Jan. 31, 1948
Jan. 11, 1974

Fairly recent grave marked with cement block. No inscription. Adult grave.

PLEAS WHITE
Born Mar. 18, 1861
Died Nov. 2, 1945
Age 84 yrs. 7 Mos. 15 days

Cement block, with no lettering.

TANNER	
MYRTLE C.	J. W.
Apr. 5, 1892	Mar. 25, 1882
Mar. 7, 1966	Jan. 11, 1963

BETTY SUE
Dau. of
J.W. & M.C. TANNER
June 29, 1916
Sept. 26, 1942

(continued)

Langston Cemetery, continued

SMITH		MILDRED LOUISE	JOHN L. SMITH	MOLLIE
WALTER H.	LENA F.	SMITH	May 16, 1880	Wife of
Mar. 10, 1895	Feb. 28, 1897	Borned & Died	Aug. 10, 1952	J.L. SMITH
July 12, 1937	(blank)	March 3, 1929		Aug. 22, 1880
Row 2:	(Illegible funeral home marker.)		PAUL SMITH	Nov. 15, 1937
=== =			Pvt US Army	Mother
			World War II	
			Sep 2 1913	PAULINE WILHELMS
			Jun 29 1977	1912 - 1935

TAYLOR		THOMAS A.	WILHELMS	
H.M. HENSLEY	JENNIE W.	THOMAS A.	JAMES	FLORENCE
1836 - 1929	July 22, 1891	April 26, 1886	HENRY	MICHAELS
	June 22, 1969	March 3, 1966	1885-1951	1887-1973
CHARLES ADLAI	BOBBY W.	WILBORN	(foot)	(foot)
CHISM	WILBORN	WALTER SCOTT	Father	Mother
Feb. 7, 1973	Jan. 3, 1943	1885-1969		
Feb. 7, 1973	June 21, 1944	(foot)		
(foot) Son		Father		

CABINESS		CISCO		FRANK TEAT CISCO
Row 3:	HAZEL W.	ELLIS H.	LFLA A.	WILL F.
=== =	1910-(blank)	1905-1974	Jan. 13, 1902	Oct. 15, 1891
			Aug. 22, 1980	(blank)
C.L. JONES			(foot) Mother	Brother
May 15, 1889	(No further info)			

GEORGE WEBESTER	MILLIE ANN HICKS	JOE C. JONES	VAUGHT	VAUGHT
JONES	Wife of	Apr. 2, 1899	MARY E. (SIS)	KELLY W.
July 21, 1866	G.W. JONES	Dec. 12, 1929	Nov. 15, 1918	Mar. 3, 1913
May 1, 1956	Sept. 8, 1861	(Masonic)	Feb. 20, 1972	Nov. 9, 1961
(Masonic)	May 18, 1938			

VAUGHT		Row 4:		HELEN HARRIS WALKER	(Scottsboro Funeral
W. MILT	ALTA P.	=== =	Feb. 9, 1896	Feb. 17, 1980	Home marker:)
Oct. 28, 1881	June 1, 1889			Beloved wife of	LOUIS ARNOLD
Sept. 10, 1952	June 14, 1967			Bertram E. Walke.	Died: September
				(foot) Auntie	8, 1980
					Aged 59 years

SECTION "B" Row 1: Unmarked grave.

PERCY GLEN	MYRTLE C. SMITH	THOMAS G. SMITH	EVA
TANNER	Born	Born	JERKINS
June 29, 1921	Dec. 25, 1918	April 20, 1915	B. in July 18,
Mar. 25, 1926	Died	Died	1885
A little bud of love	June 21, 1920	Sept. 22, 1915	Died July
		(inscription)	July 1, 1909
			At Rest

Row 2:	EMILY ADINA	NANCY OPHELIA
=== =	MICHAELS	MICHAELS
	Sept. 9, 1902	Mar. 22, 1895
	Apr. 10, 1977	Dec. 9, 1972

Row 3:
=== =

MICHAELS		ALICE dau. of	FENNELL
(foot)	(foot)	G.S. & Emma	SIBYL D.
LIZZIE B.	HORACE COLEMAN	POWELL	Aug. 1, 1903
MICHAELS	MICHAELS	Oct. 24, 1905	Sent. 13, 1977
Mar. 26, 1956	Aug. 29, 1884	July 9, 1916	(foot) Mother
(only date)	Nov. 6, 1972	(inscription)	(foot) Daddy

(continued)

Langston Cemetery, continued

DeBARDELEBEN		JEAN ROWE	WHITE	
WILLIE W. Sept. 12, 1890 Feb. 7, 1978 (foot:) Wife	FRED M. Nov. 30, 1889 July 29, 1972. (foot:) Husband	Daut. of E.L. & J.L. DOWNEY 1932	THOMAS H. Dec. 25, 1859 Apr. 7, 1937	ISABELLE Oct. 14, 1862 July 29, 1934 (inscription)
6 ft. obliisk: WHITE EMMETT WHITE Born Jan. 6, 1894 Died July 26, 1910 (inscription) (foot:) E.W.	KATIE MORE Dau of Thomas & Belle WHITE Born June 3, 1897 Died June 14, 1905 (foot:) K.M.	Row 4: ===== JEFFREY WADE Infant son of Billie & Hugh MICHAELS January 5, 1967 (foot:) J.W.M. (Masonic emblem) SAMUEL L. MICHAELS May 22, 1885 Aug. 24, 1960	Large dbl stone: MICHAELS ALLIE M. March 30, 1888 Feb. 22, 1977 (and) (Masonic emblem) JAMES F. July 30, 1879 Sept. 30, 1962	
LUCILLE FENNELL MICHAELS Dec. 21, 1897 Dec. 19, 1921 (inscription) MICHAELS (foot:) L.F.M.	JOHN H. MICHAELS Dec. 5, 1849 Feb. 12, 1921 Father and Mother	LIDDY J. MICHAELS Dec. 7, 1851 Nov. 18, 1920	(small hand-lettered in paint) MARIAH WILKINSON (no dates) WILLIE B. AUSTIN Mar. 14, 1898 June 15, 1899	
Row 5: ===== INEZ Jan. 16, 1932 May 1, 1941 (inscription) EVANS	EVANS Deed for lot 15 x 30 recorded Book 93, page 394 (over) Son WILL L. EVANS Aug. 21, 1871 Feb. 22, 1950 (Masonic)	Father ALF T. EVANS Sept. 7, 1841 Feb. 7, 1931 Co. E-55th Ala. Reg./C.S.A.		
MYERS WILLIAM Mar. 2, 1855 Nov. 13, 1932 (foot) W.M. MYERS (dates repeated)	MYERS IDA E. Aug. 13, 1866 April 4, 1959	Row 6: ===== DOSIA MORGAN Born Mar. 30, 1872 Died Aug. 28, 1922 MORGAN (foot) D.M.	WILLIAM J. MORGAN 1864-1925 Father (foot) W.J.M.	
(Footstones behind large family marker:) DORTHA LEE 1931-1938 (inscription)	MORGAN E. L. 1902-1973	VIOLA M. STEEN 1904-1965	STEEN OLLIE L. Mar. 12, 1882 June 7, 1947	HUGH R. July 4, 1879 Mar. 11, 1949
SECTION "C" ANDY ANGLES Oct. 8, 1886 Jan 20, 1973	Row 1: ===== JAMES M. GENTLE Alabama PFC CO. C 59 Armd ING BN World War II Aug 15 1925 Jan 31 1972	EDWARD LEE Son of Mr & Mrs C.L. TOTHEROW Dec 30, 1940 June 25, 1941 (inscript)	AIMA GEAN Dau of Mr & Mrs Jim MATCHEM Feb 23, 1937 June 17, 1938 (inscript)	
Row 2: ===== CYNTHIA J. SMITH BENSON April 28, 1878 April 14, 1962	SMITH S. SMITH Sept 5, 1850 March 4, 1920 Father and	SARAH E. SMITH July 7, 1856 (blank) Mother	INFANT/DAUGHTER of Rev. J.F. & Ida/CLARK Born & Died July 24, 1911 (inscrp)	

(continued)

Langston Cemetery, continued

MARY LOU Dau. of John & Fannie STANFIELD Nov. 28, 1932 Sept 28, 1934(insc)	<u>STANFIELD</u> MARY LOU Mar. 7, 1863 (blank)	<u>HENRY W</u> July 5, 1865 Feb 9, 1936	MAE/Daughter of H.W. & L. V./STANFIELD Born/Oct 21, 1888 Died/July 12, 1909 (inscription)
Row 3: === =	<u>STANFIELD</u> CHARLEY H. Nov. 21, 1886 Apr 25, 1962	<u>LUDIE</u> Nov. 19, 1902 May 14, 1973	ADDIE STANFIELD May 9, 1902 April 9, 1924
			ANNIE GERTRUDE STANFIELD Born/Sept.18, 1894 Died/Aug.5, 1903
PHOEBE S. Wife of O.H. STANFIELD Born/May 14, 1866 Died/July 9, 1910 (inscription)	O.H. STANFIELD Feb 13,/1860 Mar. 1/1927 (inscription) STANFIELD	C.L. ODOM Born Apr.7, 1866 Died Sept.23, 1921 (Masonic) ODOM	MARY E. ODOM Born Jan.31, 1877 Died Sept.24, 1919 (Forest Woodmen Circle)
(cement:) CHARLIE ODOM Born Aug 23, 1902 Died March 23, 1932	(cement:) MARY K. ODOM Born Jan 5, 1931 Died Dec 28, 1932	Row 4: === = WALLACE ANGLES Alabama Pvt. 11 Inf 5 Div April 3, 1934 (5 unmarked graves between these)	MAGGIE LEE HODGE Wife of M.M. Hodge Born Feb 1, 1897 Died Jan. 27, 1918
ODOM OLLIE B. 1889-1968	J.G. WRIGHT Feb 14, 1862 May 2, 1915	(Grave marked with fieldstone.)	DUNCAN (Dbl. stone) SUSIE K. Sept. 15, 1903 Mar. 27, 1975 (and) JAMES (JIM) Dec. 2, 1887 Dec. 30, 1966
SECTION "D" Row 1: === =	(Funeral home marker:) Mr. STEVEN L. WALLACE 1897 1976 Carr Funeral Home Guntersville, AL	WILLENE Inft. Dau. of Jim & Susie DUNCAN May 8, 1928 Aug 27, 1928	
Row 2: (3 hand- === = lettered stones:)	JIM CISCO Died May 30 1930	MARY CISCO April 5 1911	PANSEY CISCO (no date)
			JACKSON Capt. W.J. JACKSON Born 1829 Died July 12, 1913
Row 3: === =	(Funeral home marker:) HUGH BOYD LITTLE Born 5-8-1918 Died 7-10-79 Kerry Funeral Home Henager, AL	(2 graves marked with cement blocks, no inscript.) LITTLE (Dbl stone) DAN Mar. 22, 1875 Aug. 15, 1952 MINNIE Feb. 22, 1879 Oct. 17, 1957	FENNELL (Masonic) DAVID FRANK FENNELL June 24, 1874 July 7, 1949 (inscription)
F.K. Son of D.F. & L.K. FENNELL Born Feb. 9, 1907 Died April 22, 1907	Row 4: (3 Little graves === = enclosed in low brick wall- covered with crushed marble.)	LITTLE (Dbl stone) BEULAH 1904-1977 FRED 1907-1942	FENNELL "F" LILLIE KIRBY FENNELL June 28, 1878 Sept. 17, 1925 (inscription)
R.T. CALLAHAN Apr. 2, 1872 Oct. 16, 1950	Mother RUTH/CALLAHAN Jan 15 1835 Apr 1 1921/(inscript.)	(Continued in June 1982 issue)	EARNEST LITTLE Aug. 30, 1930 Aug. 3, 1931 GRIFF CALLAHAM Sept. 29, 1878 Feb. 4, 1945 (Inscription with reference to his being "Father.")

Lauderdale

WILL RECORD A
1835 - 1858

(Ninth Installment)

Abstracts of wills in Lauderdale County, Alabama, were first published in Valley Leaves, Volume 7, Number 2 (December 1972) with Will Record 3 (1821). Additional wills were published until that series concluded with the first fifty pages of Will Record A in Valley Leaves, Volume 8, Number 4 (June 1974). The current series began in Volume 14, Number 4 (June 1980). This large red 316 page volume can be found in the Lauderdale County Courthouse, Florence, Alabama. Abstracted from xerox copies of the volume by Ann E. Cochran, Huntsville, Alabama.

Pages 139-140

Will of Ephraim McCully

1 Dec 1846

Signed "X", his mark.

Direct my executors to sell:

- 1) Limestone County, AL, land NE $\frac{1}{4}$ Section 26, T2, R5W.
- 2) Lot I purchased of Isaac Brownlow's estate in Rodgersville, 8 $\frac{1}{2}$ Acres.
- 3) All personal property not exempt from administration.
- 4) 40 Acres on East side of SW $\frac{1}{4}$ Section 23, T2, R5W.

Use proceeds of above sale to pay debts and residue to my beloved wife, Amanda McCully.

Executor: Bayles E. Bourland

Witnesses: Thos. Davenport, John Cooper, Robert Shane

Proven by witnesses 29 Jan 1847 before Wm B. Wood, Judge Cty Ct.

Admitted to probate and recorded 29 Jan 1847.

Pages 140-141

Will of Benjamine Smith

26 Aug 1846

To my son, Littleton Smith, \$1.

To my daughter, Nancy Ross, \$1.

To heirs of my son, William Smith, \$1.

To heirs of my son, Shadrack Smith, \$1.

To my son, Hiram Smith, \$1.

To my daughter, Margaret Wood, \$1.

To my daughter, Narcissa Wood, \$1.

To my son, Carroll Smith, \$1.

To my son, Hambleton Smith, \$1.

Balance of estate to my dear and loving wife during her natural life, consisting of 80 Acres of land, all stock, all household goods and furniture, all tools and implements, "and after death" be equally divided amongst my sons and daughters, the heirs of her body.

Executors: Brother, William Smith, and wife, Nancy Smith.

Witnesses: Carrel Smith, Carter Blanton, William Smith.

Proven by William Smith and Carrel Smith 27 Nov 1847 (probably should be 1846 since recording date is prior to this date) before Wm B. Wood, Judge and by Carter Blanton 1 Feb 1847 before Wm B. Wood.

Recorded: 2 Feb 1847.

(continued)

Will Record A, 1835-1858, continued

Pages 141-142

Will of Phil(1)ip Wright

17 Feb 1847

Signed "X", his mark

To Nicholas Wright and wife, Bosburo Wright, 2 beds and furniture.

To William Gray, "NW $\frac{1}{2}$ of NE $\frac{1}{2}$ West containing thirty nine and 84 acres," one spotted gray mare, one sorrel horse, two cows and calves and one yearling, 3 head of sheep and all household and kitchen furniture and farming utensils and all now due Philip Wright.

To Catharine Steward, 12 $\frac{1}{2}$ cents.

To heirs of John Wright, 12 $\frac{1}{2}$ cents.

Witnesses: D. Joiner, Alexander Fields

Proven 12 Apr 1847 by Alexander Fields and Drury Joiner before Wm B. Wood, Judge.

Pages 142-143

Will of John Webb

21 Jan 1870*

*Date must be in error for will was proven in April 1847.

"Low in bodily strength"

To my beloved wife, Elizabeth, two negroes, furniture, stock and property for her to use until her death and then disposed of to my children as follows:

To my son Berry Webb "because of his obedience to me" an equal share.

To my son, James Webb, an equal share.

To my son, Henry Webb, an equal share.

To my son, Jermiah T. Webb, an equal share.

To my daughter, Nancy Song, an equal share.

To Isabella Parker and Evaline Parker, my grandchildren, and heirs of my daughter, Rebecca Parker, now deceased, an equal share.

To my daughter, Eliza, wife of Wesley Shelton, an equal share to enjoy during her lifetime and then to her children,

To Artemus Parker, because of his disobedience and divers other causes, only \$5.

To my son, Jackson Webb, because of his having married disgracefully, only \$5.

To my son, Josiah Webb, "if he should entirely forsake the woman to which he has married and should in no wise have any intercourse with her" an equal share, but "should he continue to cohabit with her" only \$5.

Upon death of my wife, Elizabeth, property should be sold and divided as directed

Because of "the industrious disposition" of my son Jermiah T. Webb "and divers other causes" he should be appointed guardian of my grand children, Evaline Parker and Isabella Parker, and for the children of my daughter, Eliza Shelton

Witnesses: Thomas and John S. Fielder.

Proven by witnesses 24 April 1847, Wm. B. Wood, Judge.

Recorded: 25 April 1847.

Pages 143-146

Will of Col. (Rob)(ert) Tinnen

25 Mch 1847

"Weak in body"

Keep property together to make crop and crop sold. Perishable property sold at public auction.

Debts paid from money and balance to my brothers and sisters alive and children of those dead.

To Dr. Waddy Tate, 17 slaves, for his use in his lifetime and after his decease, to his sons, Waddy Tate Jr., Frederick Tate, William Tate and Phocian Tate.

To my brother, David, and Catlett Tinnen of NC, rest of slaves except Ellick (or Alexander), who is to be set free in NC with \$100, a horse and saddle worth \$75. The remaining Negroes should be sold in Florence if they desire to stay in this area.

(continued)

Will Record A, 1835-1858, continued

Will of Col. Robert Tinnen, continued

To Martha Brandon, daughter of Washington Brandon, \$200 (from sale of lands in AL and MS) to be used to purchase her a Negro girl.

Executors are directed to sell lands in AL and MS with profits from sale to be disposed of as directed.

Executors: James H. Weakly and Sidney C. Posey of Alabama, and my brother, David Tinner, of North Carolina.

Addition to Will:

To Frederick Tate, son of Waddy Tate, 10 shares of stock in the Florence Bridge Company,

To my brother, Catlett Tennin, of North Carolina "my gold watch with the chain seal and key to be worn by him during his life and then to go to his eldest Son living."

To my sister, Mary Fancett, of North Carolina, the remnant of my wife's jewelry which I have.

Signed Rob Tennin.

Witnesses: Jas. Irvine, H.J. Posey, W.M. Brandon.

Proven by James Irvine, Hampton J. Posey and Washington M. Brandon before Wm B. Wood, Judge, 12 May 1847.

Recorded: 12 May 1847.

Pages 146-148

Will of Elizabeth Calahan

23 Mch 1843

To my son, John T. Calahan, S $\frac{1}{2}$ SW $\frac{1}{2}$ Sec 2, T1, R8W (80 A.), "my residence wherein I now live"

My kitchen furniture, farming tools and some household furniture and stock sold to pay debts.

My beds and furniture and wearing apparel divided so each of my children will eventually get an equal amount: William and Nancy Stapler; William and Rachael Calahan; William and Mary Romine; George and Betsey Ann Stanford; John T. and Sarah Ann (Calahan?); James F. and Mariah (Calahan?); Eli J. and Clarinda (Calahan?); Marshall and Matilda Masterson get \$5 if they personally appear, but no more as they already have received more than the other children.

Executor: Mark Shelton, Esqr.

Witnesses: Samuel D. Poteet, Ephraim Wilburn, Renney Belew.

Proven by Ephraim Wilburn and Rainey Balew (Samuel D. Poteet has since died) 28 June 1847 before Wm B. Wood, Judge.

Page 148

Will of Adaline R. Graves
Nuncupative Will

4 Aug 1847

A few hours before her death on Wednesday morn 4 Aug 1847, she requested that her property be divided as follows:

To her sisters, Isabella Houston and Elizabeth Warren, all bed, furniture, etc. in possession of Isabella (divided equally between them) except a Marsailles quilt which she gave to Elizabeth Burtwell, daughter of John T. Burtwell of Florence.

To her sister, Margaret Smith, all wearing apparel

And after paying debts, including her deceased mother's \$10 debt to Robert M. Patten plus interest, house and lot in Florence divided between Margaret Smith, her sister, 2/3, and Decatur Graves, her nephew, 1/3.

(continued)

Will Record A, 1835-1858, continued

Will of Adaline R. Graves, continued

To John Weakley, son of Samuel D. Weakley, her clock and desk.

Witnessed: Samuel D. Weakley, Eliza B. Weakley, Caroline M. Burtwell (also given as Cornelia M. Burtwell), Elizabeth (X) Jenkins, and Nancy Glenn
Sworn to 9 Aug 1847 before Wm B. Wood, Judge.
Recorded 15 Aug 1847.

Pages 148-149

Will of John Donohoo

26 June 1847

To son, William, \$100.

To son-in-law, Lewis D. Vesier, \$100.

To Samuel R. Garner, other son-in-law, \$100 and 4 slaves (named) for benefit of Samuel's children.

Sell land, stock of cattle, horses, hogs, property and crop (of which I own $\frac{1}{2}$), and divide proceeds equally between my son, William, and my sons-in-law, Viser and Garner.

Executors: Samuel R. Garner, Lewis D. Viser

Witnesses: Levi (blank, Todd later) and S.D. Crunk

Proved 19 Aug 1847 by Levi Todd and Samuel D. Crunk before Wm B. Wood, Judge.

Pages 149-153

Will of John Chisholm

16 July 1847

My plantation in Panola Co., MS, be carried on for 5 years by my executors. Executors should sell my lots in Oxford and Belmonte, MS, and other land in MS except plantation above.

About 5 years ago I conveyed land on which I now live to Dr. Pugh Houston as protection for him against loss as my security in debts which are nearly now all paid. He should convey this land to my sons, Toliver S. Chisholm, and John W. Chisholm reserving my wife's interest for her. Stock on homestead and 5 slaves (named) to my wife for her lifetime.

To Pugh Houston, 2 slaves (named) in trust for my daughter, Melissa (many eventualities mentioned)

To Pugh Houston, 2 slaves (named) in trust for my daughter, Hetty, (eventualities)

To Pugh Houston, 1 slave (named) in trust for my daughter, Francis, "

To Dr. Pugh Houston for friendship and services to me, \$500.

To son, John W. Chisholm, \$1,000 for use without interest until 1 Jan 1853.

As soon after 1 Jan 1853 as practical, executors should arrange estate for division equally among my children.

Executors: Wife, Esther Chisholm, my son-in-law Doctor Pugh Houston, and my sons Toliver S. Chisholm and John W. Chisholm.

Witnesses: H.J. Posey, W.C. Dellahunty, Hervey Dellahunty.

Proven 30 Aug 1847 before Wm B. Wood, Judge, by Hervey Dellahunty, Hampton J. Posey, and William C. Dellahunty.

(Date of recording not given.)

(Continued in next issue)

POPE BUYS FLORENCE HOTEL

Thos. S. Pope, late of Russellville, Ala., begs to inform that he has taken the Florence Hotel (sign of the Indian Queen), where he will accommodate travellers. House built by The Cypress Land Co, etc..... from The Nashville Whig, Nashville, TN, 2 Feb. 1824 issue, page 4, column 1.



Lawrence



TRACT BOOK

This large red book, located in the Lawrence County Courthouse, Moulton, Alabama, is entitled "Tract Book." The section, township and range were copied for publication by Mary Fran Destree Moore, Torrance, California. This series began in Valley Leaves, Volume 14, Number 1 (September 1979). This is the eleventh installment.

CORRECTION: On page 76 of the last issue of *Valley Leaves*, Volume 16, Number 2, (December 1981), the Township for Sections 9, 10, 11 and 12 should read, "Twp 4S R 7W." Please make this correction on your copy.

DESCRIPTION OF THE TRACT	TO WHOM CONVEYED	WHEN CONVEYED	NUMBER OF CERTIFICATE	DATE OF MILITARY ACT
-----------------------------	------------------	------------------	--------------------------	-------------------------

Page 68 (continued)

Twp 4S R 7W				
Sec 17	State	23 May 1828		
	River Improvements			
	W.F. Moseley	11 Feb 1830		
	Dabney Morriss, Lewellen Jones			
	and James Madison	10 Sep 1818	62	
	William F. Moseley	10 Sep 1818	1777	
Sec 18	John F. Moseley	10 Sep 1818	118, 117	
	State	23 May 1828		
	River Improvements			
	Wm Banks	26 Nov 1829		
	J.F. Moseley	1 Feb 1830		

Page 69

Twp 4S R 7W				
Sec 19	State	23 May 1828		
	River Improvements			
	John F. Moseley	1 Feb 1830		
	Tho. Moseley	10 Mch 1830		
	Irwin Davis	12 Mch 1830		
	Joseph Trotter	10 Sep 1818		
Sec 20	State	23 May 1828		
	River Improvements			
	Orrin Davis	12 Mch 1830		
	John A. Walker	10 Sep 1818	1470	
	Orrin Davis	28 May 1831	4023	
	Oran D. Davis	10 Sep 1818	1128	
Sec 21	State	23 May 1828		
	Saml Watkins	2 Dec 1829		
	P.J. Watkins	2 Dec 1829		
	G.T. Sadler	5 Feb 1830		

Page 70

Twp 4S R 7W				
Sec 22	Samuel Watkins	10 Sep 1818	152, 2383	
	State	23 May 1828		
	River Improvements			
	S. Watkins	2 Dec 1829		
	E. McAlister	26 Nov 1829		
	Paul J. Watkins	19 Oct 1830	3475	
	Thomas Pointer	19 Oct 1830	3477	
Sec 23	State	23 May 1828		

(continued)

Tract Book (continued)

DESCRIPTION	TO WHOM CONVEYED	WHEN CONVEYED	CERTIFICATE	MILITARY ACT
Page 70(continued)				
Twp 4S R 7W				
Sec 23 (continued)				
	River Improvements			
	Moses Carlock	30 Jan 1830		
	Wm Carpenter	23 Feb 1830		
	E. McAlister	26 Nov 1829		
	Moses Carlock	10 Sep 1818	2241	
	Moses Carlock	21 Dec 1830	3786	
	Saml Watkins	21 Dec 1830	3785	
Sec 24	Flowers Walker	19 Oct 1830	3480	
	Paul J. Watkins	19 Oct 1830	3496	
	State	23 May 1828		
	River Improvements			
	Moses Carlock	1 Dec 1829		
	H.A. Anderson	15 Jan 1830		
	John Volna Peel	9 Mch 1830		
	H.A. Anderson	17 Mch 1831		
	Saml Watkins	24 Apr 1832		
	W. Fitzgerald Jr.	14 Jan 1836		
Page 71				
Twp 4S R 7W				
Sec 25	State	23 May 1828		
	River Improvements			
	H.A. Anderson	15 Jan 1830		
	Hunter Peel	9 Mch 1830		
	Hunter Peel	22 Apr 1830		
	H.A. Anderson	22 Apr 1830		
	C. Anderson	22 Apr 1830		
	Volney Peel	22 Apr 1830		
	Albert Peel	22 Apr 1830		
Sec 26	State	23 May 1828		
	River Improvements			
	Hunter Peel	9 Mch 1830		
	E. Dandridge	2 Dec 1829		
	H. Peel	9 Mch 1829		
	Hunter Peel	10 Sep 1818	1790, 1792, 1793	
Sec 27	Edmund McKallister	29 Jun 1831	1049	
	State	23 May 1828		
	River Improvements			
	Henry Peebles	10 Mch 1830		
	Wm. Elliott Jr.	10 Mch 1830		
	Paul Hildrith	30 Mch 1830		
Page 72				
Twp 4S R 7W				
Sec 28	State	23 May 1828		
	River Improvements			
	R.G. Moseley	4 Mch 1830		
	Henry Peebles	10 Mch 1830		
	R.H. Dandridge	23 Mch 1830,	31 Mch 1830	
Sec 29	William H. Whitaker	25 May 1831	3985	
	State	23 May 1828		
	River Improvements			
	W.H. Whitaker	29 Mch 1830		
	F.W. Michaux	22 Mch 1830		

(continued)

Tract Book (continued)

DESCRIPTION	TO WHOM CONVEYED	WHEN CONVEYED	CERTIFICATE	MILITARY ACT
Page 72 (continued)				
Twp 4S R 7W				
Sec 29 (continued)				
	John Robert & Eliza Woodfin heirs of James Woodfin	10 Sep 1818	215, 216	
Sec 30	Gilbert O.R. Mitchell	(See Misc. 23, page 322)		
	State	23 May 1828		
	River Improvements			
	W.H. Whitaker	24 Nov 1829,	3 Feb 1830	
	F.W. Michaux	3 Dec 1829,	22 Mch 1830	
	Thomas M. Curry	10 Sep 1818	235	
	(See Misc. 22, page 724)			
	Wm. H. Whitaker, James W. Camp, & others, Trustees of Courtland Land Company	10 Sep 1818	887	
	Gambill Peus for the heirs of Henry Willis, dec'd	8 May 1820 29 Dec 1829		Acts of Congress
Page 73				
Twp 4S R 7W				
Sec 31	State	23 May 1828		
	River Improvements			
	Danl. Wade	24 Nov 1829		
	D.S. Bynum	1 Feb 1830		
	J.M. Swoope	10 Mch 1830		
Sec 32	State	23 May 1828		
	River Improvements			
	J.K. Swoope	28 Jan 1830,	10 Mch 1830	
	John Evans	12 Mch 1830		
	A. Blocker	19 Mch 1830		
Sec 33	Littleberry H. Jones	10 Sep 1818	1669	
	State	23 May 1828		
	River Improvements			
	John Glass	25 Nov 1829		
	Wm Lynn	13 Feb 1830		
	R.G. Moseley	5 Mch 1830		
	H. Peebles	10 Mch 1830		
	Heirs of Jno. R. Bedford	25 Feb 1831		243 Acts of Congress
Page 74				
Twp 4S R 7W				
Sec 34	Benjn. Sherrod	10 Sep 1818	1136	
	LeRoy Pope (Henry Stokes' ass)	"	300	
	River Improvements			
	Henry Peebles	10 Mch 1830		
	Freeman Goode	24 Feb 1830		
Sec 16	Ina Lee Rebman	10 Oct 1932		
	Edgar S. Ballentin	12 Mch 1934		
Sec 35	State	23 May 1828		
	Jos ^a Wingo	16 Mch 1830		
	W. Fitzgerald	16 Mch 1830		
	H.F. Farley	3 Dec 1829		
Sec 16	Mrs. Annie Chardovayne	29 Apr 1934		
Sec 36	State	23 May 1828		
	Richard Gaines	12 Mch 1829		
	Saml Elliott	19 Nov 1829		
	Jos ^a Wingo	16 Mch 1830		
	H.F. Farley	23 Jan 1830		
	Richard Gains	13 Oct 1832	1516	(continued)

Tract Book (continued)

DESCRIPTION	TO WHOM CONVEYED	WHEN CONVEYED	CERTIFICATE	MILITARY ACT	
Page 75					
Twp 5S R 7W					
Sec 1	State	23 May 1828			
	E. Moseley	23 Feb 1830			
Sec 2	P. Hopkins	23 Feb 1830			
	Thos & Matthew Clay-legal reps of Matthew Clay	31 Dec 1830	135		
	State	23 May 1828			
	F.A. Clay	16 Mch 1830			
	F. Goode	23 Feb 1830			
Sec 3	Benjn. Sherrod	11 Sep 1818	1135		
	Matthew Clay	11 Sep 1818	2361		
	Benjn. Sherrod	11 Sep 1818	1134		
	River Improvements				
	John Glass	25 Nov 1829			
Page 76	Tho Pearson	26 Nov 1829			
	Jesse Glass	2 Dec 1829			
	Isaac Dukeinanin	26 Jan 1830			
	Wade Bynum	11 Mch 1830			
	Twp 5S R 7W				
Sec 4	Alexr McQuise & Jas. Hogan	11 Sep 1818	133		
	John Glass	23 May 1831	3980		
	State	23 May 1828			
	Sarah Lane	8 Jan 1830			
Sec 5	Job Baker	22 Mch 1830			
	State	23 May 1828			
	Job Baker	26 Nov 1829			
	John Evans	12 Mch 1830			
	J.K. Swoope	28 Jan 1830			
	Andrew Rand	1 Mch 1830			
	John Rand	1 Mch 1830			
	J.J. Ormand	1 Mch 1830			
Sec 6	J.K. Swoope	22 Apr 1830			
	State	23 May 1828			
	J.P. Mays	30 Jan 1830			
	Benj. Ward	9 Feb 1830			
	John White	12 Feb 1830			
Page 77	Wm. Boothe	19 Feb 1830			
	Twp 5S R 7W				
	Sec 7	State	23 May 1828		
		John R. Watson	8 Mch 1830		
		Jas. Pearsall	9 Sep 1830		
		John White	12 Mch 1830		
		J.B. Watson	8 Mch 1830		
		Danl. Gilchrist	28 Jan 1839	2114	
Danl. Gilchrist		21 Aug 1838	11985		
Danl. Gilchrist		29 Jan 1839	12115		

(To be continued)



Myers Cemetery, continued

<u>GIBSON</u>		TREVA BARBER NELSON	BERTHA VIOLA HORTON	MONTENGA RANEY
MARY LUKE	Jan. 19, 1884	July 24, 1892	Dec. 20, 1829	
1812-1887	1861	July 1, 1950	Jan. 23, 1906	Jan. 26, 1901
WILLIAM RANEY	JOHN A. LAPINGTON	ELIZABETH B.	<u>GLASS</u>	
Oct. 11, 1822	Jan. 18, 1850	wife of	JAMES W.	DAVID J.
Dec. 25, 1878	Dec. 7, 1902	J.A. LAPINGTON	Dec. 26, 1949	Oct. 31, 1952
		Nov. 26, 1832	Aug. 25, 1968	Aug. 25, 1968
BARBARA ANN WEBB	JOSEPH A. BOYD	Feb. 12, 1899	brothers	
Aug. 5, 1933	1876-1965			
Feb. 14, 1934		<u>BOYD</u>	<u>WEATHERFORD</u>	
		SARAH E.	WILLIAM F.	ELMER
MARY A. GOODIN	SARAH RIGGS	June 7, 1904	Oct. 21, 1909	Jan. 9, 1869
1868-1923	May 5, 1850	June 6, 1967	May 21, 1969	April 11, 1929
	Mar. 14, 1922			(and) (double)
THOMAS A. GOODIN	R.G. RIGGS	DANIEL TOUCHSTONE		LULA M. RIGGS
1866-1921	May 13, 1847	Co. A 32 Tenn. Inf.		wife of E.H.
	June 27, 1914	CSA		WEATHERFORD
GRACE A. RIGGS	VAN B. RIGGS	EVELYON MAE LOVELL		Sept. 6, 1873
wife of	Aug. 18, 1884	Dau. of		June 19, 1925
W.D. FOGG	Oct. 3, 1905	Mr. & Mrs. W.P. Lovell		
Mar. 17, 1882		Born & Died May 15, 1938		ROSSIE
Mar. 23, 1917				Dau. of
				J.H. & H.E. NEWBY
MINNIE GIBSON	JACK RUSSELL	ADA S. MYERS		Jan. 19, 1893
wife of	Son of	wife of		Jan. 22, 1893
Andrew M. SHELTON	S.M. & A.S. GIBSON	Sam. M. GIBSON		
and Daughter of	Mar. 28, 1899	May 22, 1859		Sgt. W.M. AUSLEY
Samuel and Ada Gibson	Feb. 1, 1900	July 6, 1915		Co. H. Tenn. Cal.
June 22, 1884				
Nov. 29, 1966	<u>LAPINGTON</u>	SAMUEL MONROE GIBSON	GASSENEY MAE GIBSON	
	LYDIA	Sept. 22, 1853	Jan. 20, 1896	
MACK	1853-1889	Feb. 14, 1931	Mar. 21, 1898	
	JAMES			
LAPINGTON	1853-1922			
Aug. 20, 1883	ELORA GRIFFIN	KINNETH ARNLD	HOWARD GILBERT JARRETT	
Jan. 22, 1913	wife of	son of	son of	
	Leo JARRETT	Leo JARRETT	Leo & Elora Jarrett	
ELIZA E.	Mar. 12, 1912	July 22, 1932	April 13, 1930	
wife of	May 23, 1937	July 23, 1932	Feb. 17, 1942	
James A. SIMPSON	EUNICE PEARL	WM. A.	JOHN H.	
Sept. 28, 1822	Dau. of	son of	son of	
Sept. 15, 1886	J.H. & S.R. SIMPSON	J.H. & S.R. SIMPSON	J.H. & S.R. SIMPSON	
	June 16, 1896	Aug. 27, 1885	Mar. 8, 1887	
MARY E.	Nov. 16, 1902	Sept. 10, 1885	April 25, 1887	
Dau of				
J.H. & S.R. SIMPSON	NELLIE W.	INFANT DAU. of	G.R. MYERS	
May 13, 1888	Dau. of	J.D. & S.S. BLACK	May 18, 1844	
Aug. 4, 1888	J.H. & S.R. SIMPSON	Sept. 30, 1881	June 11, 1889	
	April 5, 1893			
K. AMMON	Oct. 7, 1895	NELLIE BEAUFONE BLACK	S.F. MYERS	
dau. of		Oct. 10, 1901	wife of	
M.L. & E. BROWN	JAMES L. LAPINGTON	Oct. 23, 1913	G.R. Myers	
May 23, 1907	June 11, 1877		Nov. 1, 1845	
Sept. 13, 1909	Nov. 19, 1896	IDA PEARL BLACK	Aug. 26, 1919	
		wife of		
POLK GIBSON	CHARLIE S. LAPINGTON	C.E. HARDISON	O.R. MYERS	
Died 1918	Aug. 24, 1875	June 23, 1895	May 18, 1844	
	Oct. 23, 1894	Jan. 3, 1921	June 11, 1889	

Myers Cemetery, continued

CINDY LOCK GIBSON
Died 1916

ROSA
Dau. of
Robert L. McGILL
Nov. 17, 1902
June 2, 1913

A.H. (DICK) GREENHAW
Feb. 25, 1853
Dec. 14, 1913

WILLIAM GOODIN
1909-1969

MARY E.
Dau. of
T.A. & M.A. GOODWIN
April 4, 1887
Nov. 25, 1887

BULAH
Dau. of
T.A. & M.A. GOODWIN
May 18, 1897
Feb. 28, 1899

RUIE M.
Dau. of
T.A. & M.A. GOODWIN
Oct. 31, 1888
Dec. 1, 1898

ARCHIE
Son of
T.A. & M.A. GOODWIN
Dec. 10, 1895
Mar. 10, 1901

-End of Myers Cemetery-



GONE
TO
TEXAS . . .

SAMUEL FRENCH
(Limestone County, Alabama)

HEADRIGHT CERTIFICATE, 2ND CLASS



The State of Texas
County of Bastrop

SAMUEL FRENCH is entitled to Twelve hundred and Eighty acres of Land by virtue of Certificate No. 1145 dated October 1st 1837 granted to him by the Board of Land Commissioners for the County of Harrisburg he having proved to us that he has resided in the State Three years and done and performed all the duties required of him as a citizen.

Given under our hands at Bastrop November 27th 1849.

James Smith Chief Justice
Exofficio Prest. Board of Land Com^{rs}
R. H. Grimes }
A. Mayes } Co. Comrs.
Thos. H. Mays }

Attest
James H. Gillespie Clk Co. Court
Exoff. Clk B. L. Comrs.

From a photostatic copy of the original document on file in the State of Texas General Land Office, Records Division, Austin, Texas. Contributed by Mrs. V. W. Hamner, Jr.

DEATH NOTICES FROM THE ATHENS POST

1872

Death notices from microfilm copies of The Athens Post (located in the Athens Public Library) were abstracted by Marjorie Shelton Kent in February 1975. Those for 1869 were published in December 1981 issue of Valley Leaves. Dates are date of death except as noted.

- 25 Dec 1871: Mr. John Edward Allison of Athens, brother of H. Allison, died in Plumbayou, Ark.
 3 Feb 1872: Mr. Joel B. Pugh, near Gilbertsboro.
 14 Feb 1872: Mrs. Lizzie H. Crenshaw, wife of John W. Crenshaw, daughter of Col. Joseph Petty. Buried in Athens City Cemetery.
 12 Mch 1872: Mrs. Martha Tucker, 75.
 20 Mch 1872: M.H. Hebrood.
 7 Mch 1872: Mrs. Sallie W. Morgan, wife of H.B. Morgan.
 26 Mch 1872: Mrs. Parthenia T. Higgins, daughter of Mrs. Rebecca Hendricks, wife of John J. Higgins. Born 17 Dec 1841.
 26 Mch 1872: Jacob Hamilton.
 30 Dec (Probably 1871, though not stated.-Editor): Mrs. Sarah Raisler, wife of Hon. Chas. W. Raisler, daughter of Rufe C. Stinnit.
 5 Apr 1872: Mrs. Fannie Jones, wife of Capt. David Jones, daughter of Ash Allen.
 26 Apr 1872: Thomas T. Skinner, age 36, born in South Carolina.
 7 Jun 1872: James Williams, 76, from Georgia.
 16 Jun 1872: Mrs. Elizabeth Gilbert, 70 years old.
 13 July 1872: Mrs. Mattie Boggen, at home of Mrs. C.B. McKinny.
 1 Aug 1872: Mrs. Mary C. McElyea, wife of Wm. C. McElyea.
 2 Apr 1872: Mrs. Jas. L. Martin, wife of Jno. A. Milhous. (?-Editor)
 18 Aug 1872: Mrs. Annie Hobbs, wife of Thomas and sister of Capt. Jas. Benaugh.
 Sep 1872 (No day listed.-Editor): Peterson Tanner, born in North Hampton Co., North Carolina, 20 June 1809. Moved from North Carolina to Madison County, Ala., then to Limestone County. 68 years, 2 months, and 16 days old.
 8 Sep 1872: William Hamilton, age 65.
 17 Sep 1872: Miss Eliz. Elliott, at home of Rev. James Elliott.
 21 Sep 1872: Wm. Anthony Elliott.
 18 Sep 1872: Wm. Cunningham, formerly of Pulaski, Tenn., now resident of Athens. Died in Huntsville.
 6 Nov 1872: Sterling Jackson, age 88, at home of his son in Pulaski.
 24 Nov 1872: Lizzie Lane, eldest daughter of Wm. N. and Mary Hayes.
 8 Dec 1872: Mrs. Hagood, wife of Charles B. Haygood.
 7 Dec 1872: Caroline Elliott, daughter of James C. Elliott.

 ← REGARDING 1869 DEATH NOTICES FROM THE ATHENS POST →

In Valley Leaves, Volume 16, Number 2 (December 1981, page 82, 1869 dates listed were dates of newspapers except for the following which were death dates:

- | | | |
|-------------|--------------|-----------------------------|
| 22 Dec 1868 | (death date) | Judge Sydney C. Posey |
| 14 Jan 1869 | (death date) | John W. Mitchell |
| 18 Mch 1869 | (death date) | Mr. James P. Roberts |
| 25 Mch 1869 | (death date) | Dr. G.W. Whitfield |
| 29 Jul 1869 | (death date) | James B. Barnes |
| 4 Jul 1869 | (death date) | Amos French |
| 17 Jul 1869 | (death date) | Samuel Bennett Higgins |
| 21 Aug 1869 | (death date) | Thomas Hill Malone |
| 14 Sep 1869 | (death date) | Mrs. Nannie Buck McWilliams |
| 23 Sep 1869 | (death date) | Little Benny Irvin |
| 20 Sep 1869 | (death date) | Mrs. Martha Easter |
| 21 Oct 1869 | (death date) | Carrie Cartwright |
| 5 Nov 1869 | (death date) | Mr. R.A. Parkham |
| 20 Nov 1869 | (death date) | Lawrence DeMoval Cartwright |



Madison



RECORDS OF THE FIRST BAPTIST CHURCH
GURLEY, ALABAMA
1884 - 1915

SECOND INSTALLMENT

The records of Gurley's First Baptist Church were obtained for T.V.G.S. by member, P.B. Keel. They are presented as copied and sometimes abstracted from the Register. The page numbering was assigned our Xerox copy and is not found on the original. Prepared by Ann E. Cochran, Huntsville, Alabama. This series began in Valley Leaves, Volume 16, Number 2, December 1981.

(Page 10)

OFFICIAL REGISTER.-DEACONS.

Echoles D.H.	Commenced May 1884; Closed "Deceased" (Date Dec 31st 1893 was written in another hand above Deceased, however later records indicate that this is the death date for T.S. Echols-Editor); Remarks "was Deacon in the Church where it was moved to Gurley."
Branum Wm Sr.	Commenced Aug 1888; Closed "Deceased"; Remarks "was Deacon in home Church when he came to us."
Burks J.B.	Commenced Jany 22nd 1893; Closed "Letter"; Remarks "Ordained Jany 22nd 1893."
Beason, F.R.	Commenced Jany 22nd 1893; Closed "Lettered Off" (Date April 8th 1900, is written above.-Editor); Remarks "Ordained Jany 22nd 1893."
Grimmett, M.O.	Commenced Jany 22nd 1893; Closed "Lettered Off;" Remarks "Ordained Jany 22nd 1893."
Roberts, W.T.	Commenced Jany 22 1893; Closed "Deceased Dec. 3, 1914;" Remarks "Ordained Jany 22nd 1893."
Branum W.T.	Commenced Jany 13th 1895; Closed "New Book Aug 15, 1915;" Remarks "Elected Dec 23rd 1894."
Leftwich C.W.	Commenced April 22/1900; Closed "Dec. 31, 1905 Letter;" Remarks "Accepted by letter April 22, 1900."
Hodges, A.S.	Commenced Jan 24th 1909; Closed "New Book Aug. 15, 1915."
Styles Dawson	Commenced Jan 24th 1909; Closed "New Book Aug. 15, 1915."

(Page 11)

OFFICIAL REGISTER.-ADVISORY COMMITTEE

Wm Branum	Commenced Oct 28th 1894; Died.
W.T. Roberts	Commenced Oct 28th 1894; Died Dec. 3, 1915? (1914 elsewhere).
M.O. Grimmett	Commenced Oct 28th 1894; Lettered off.
J.B. Burks	Commenced Oct 28th 1894; Lettered off.
F.R. Beason	Commenced Oct 28th 1894; Closed "April 8th 1900;" Lettered off.
W.T. Branum	Commenced Jan 13th 1895; See New Book.
W.H. Beason	Commenced Oct 28th 1894; "
J.A. Jacobs	Commenced Oct 28th 1894.
J.W. Echoles	Commenced Oct 28th 1894; Died.
Tyson Sloan	Commenced Oct 28th 1894.
R.L. Butler	Commenced Oct 28th 1894; Lettered off.
C.W. Leftwich	Commenced April 22nd 1900; Lettered off.
J.F. Collier	Commenced May 10th 1904; See New Book.
W.T. Williams	Commenced May 10th 1904; Lettered off.
A.S. Hodges	Commenced Jan 24th 1909; See New Book.

(continued)

Records of the First Baptist Church, Gurley, Alabama, continued

(Pages 33a, 33b, Membership List I, continued)

Chronological Register		Church recv'd from, dis-	Hand of
#	#	missed to, or Baptism date	Fellowship
13	11	James Harless Addition by Letter June 1884; Loss by Erasure.	Debows Point
14	12	Margret Pugh Addition by Letter June 1884; Loss by Erasure.	Debows Point
15	13	L.L. Carmack Addition by Letter June 1884; Loss by Erasure.	Debows Point
16	14	Jane Carmack Addition by Letter June 1884; Loss by Erasure.	Debows Point
17	15	C.C. Anderson Addition by Letter June 1884; Loss by Erasure.	Debows Point
18	16	L.A. Poteet Addition by Letter June 1884; Loss by Exclusion, March 1887.	Debows Point
19	17	Sofronia Poteet Addition by Letter June 1884; Loss by Erasure.	Debows Point
20	18	Mitti Carmack Addition by Letter June 1884; Loss by Erasure.	Debows Point
21		A.V. Carter Addition by Letter June 1884.	Debows Point
22		J.W. Echoles Addition by Letter June 1884.	Debows Point
23	19	James Champion Addition by Letter June 1884; Loss by Erasure.	Debows Point
24	20	Mary J. Champion Addition by Letter June 1884; Loss by Erasure.	Debows Point
25	21	Mary Sweat Addition by Letter June 1884; Loss by Erasure.	Debows Point
26	22	Martha Sheals Addition by Letter June 1884; Loss by Erasure.	Debows Point
27	23	Geo Wells Addition by Letter June 1884; Loss by Erasure.	Debows Point
40		B.C. Miller Addition by Letter May 1885.	Debows Point May 1885
28	24	F.J. Rigney Loss by Letter April 1885.	Debows Point
29	25	L.E. Rigney Loss by Letter April 1885.	Debows Point
30	26	Mary Carmach Loss by Erasure.	Debows Point
31	27	Lucy Mayfield Loss by Erasure.	Debows Point
32	28	Lucrecy Blankenship Loss by Erasure.	Debows Point
33	29	Jane Wardworth Loss by Erasure.	Debows Point
34	30	Margret Carter Loss by Erasure.	Debows Point
35	31	Ike Sisk Addition by Letter Sept. 1884; Loss by Erasure.	(blank) Sept 1884
43	32	Nancy R Oneal Addition by Baptism Oct 1885; Loss by Letter Sept 1888.	October 1885 Oct 1885
42		W.T. Roberts Addition by Letter July 1885; Loss by "Deceased?"	Hurricane Grove Church July 1885
(Pages 34a, 34b)			
53		Simion S. Styles Addition by Letter March 1887.	Sharps Cove Church March 1887

(continued on next page)

Records of the First Baptist Church, Gurley, Alabama, continued

(Pages 34a, 34b, Membership List I, continued)

Chronological Register		Church recv'd from, dis-	Hand of
#	# Names	missed to, or Baptism date	Fellowship
54	Marthy Styles	Sharps Cove Church	March 1887
	Addition by Letter	March 1887.	
55	W H Beason	Mt Nebo church	July 1887
	Addition by Letter	July 1887.	
56	Nancy J. Beason	New Market Church	July 1887
	Addition by Letter	July 1887.	
57	Olevia C. Roberts	Cumberland Mountain	July 1887
	Addition by Letter	July 1887.	
58	Francis Husley	Trenton Church	July 1887
	Addition by Letter	July 1887.	
59	W.N. Beason	Mt Nebo Church	July 1887
	Addition by Letter	July 1887	
60 33	E.C. Picket	Oct September 1887	Oct Sept 1887
	Loss by Excluded.		
61	W ^m Branum	Cedar Point Church	Aug 1888
	Addition by Letter	Aug 1888.	
62	Marry S. Branum	Cedar Point Church	Aug 1888
	Addition by Letter	Aug 1888.	
63	Nancy A. Branum	Cedar Point Church	Aug 1888
	Addition by Letter	Aug 1888.	
36	Jonathan Beason	Mt. Nebo Church	May 1884
	Addition by Letter	May 1884.	
37	Mrs. Saline J Branum	Cave Spring Church	May 1884
	Addition by Letter	May 1884.	
38	Nannie Branum	May 1884	May 1884
	Addition by Letter	June 1884.	
39 34	Elizabeth Blankenship	Trenton Church	June 1884
	Addition by Letter	June 1884; Loss by Letter	March 1886.
41	C.A. Echoles	May 1885	May 1885
	Addition by Baptism	May 1885.	
64 35	Miss Willie Rogers	(blank)	(blank)
	Addition by Experience	Nov. 1885; Loss by Erasure.	
65	Miss Julie E Branum	November 1885	Nov 1885
	Loss by "Deceased"	("Deceased" is written under Erasure and Death.)	
44 36	Mrs John Ganter	July 1886	July 1886
	Addition by Experience	June 1886; Loss by "Deceased"	(as above).
45	Martha J Woodall	Sept 1886	Sept 1886
	Addition by Experience	Sept. 1886.	
46 37	Willie M. Owens	Sept 1886	Sept 1886
	Addition by Experience	Sept. 1886; Loss by Erasure.	
47 38	Mollie Webster	Sept 1886	Sept 1886
	Addition by Experience	Sept 1886; Loss by Deceased.	
48	Annie Webster	Sept 1886	Sept 1886
	Addition by Experience	Sept 1886.	
49	Mrs Mollie Branum	Sept 1886	Sept 1886
	Addition by Experience	Sept. 1886.	
50 39	J.A. Wilson	Sept 1886	Sept 1886
	Addition by Experience	Sept. 1886; Loss by Erasure.	
51 40	W.B. Lawtharp	Trenton Church	Sept 1886
	Addition by Letter	Sept 1886; Loss by Deceased.	
52 41	Sarah Wooten	Plesant Mt Church	March 1887
	Addition by Letter	March 1887; Loss by Letter	June 1889.
66	Rev. L.W. Woodall	Plesant Mt Church	June 1889
	Addition by Letter	June 1889.	

(Series to be continued in June 1982 issue)

Mortality Schedule

Copied from microfilm. The original book is in the Alabama Archives, Montgomery, Alabama. Only the white deaths are transcribed. Column 5, pertaining to color, and columns 8 and 9, pertaining to foreign birth of father and mother, are omitted. Foreign birth of a parent is given in parentheses where applicable. Transcribed by Dr. and Mrs. Ezell Terry, Huntsville, Alabama.

SCHEDULE 2. Persons who Died during the Year ending 1st June, 1870, in (blank) in the County of Madison, State of Alabama, enumerated by me, James H. Bell, Ass't. Marshal.

No. of family in schedule 1	Name of every person who died during the year ending June 1, 1870, whose place of abode at time of death was in this family	Age	Sex	Married or widowed	Place of Birth	Month died	Occupation	Disease or cause of death
1	2	3	4	6	7	10	11	12
12	Adkins, Mary	79	F	M	GA	Feb 7	Keep house	Pneumony
67	Lambert, Jas L.A.	7	M	S	AL	Jan	At Home	Typhoy fever
94	Pesnell, John K	43	M	M	AL	Feb 11	Miller	Killed by unknown party; Homocide
12	Higginbottam, Lacie	67	F	M	GA	Apr	Keep house	Jaundis, yellow
64	Oliver, Allen	38	M	M	SC	July 69	Farmer	Cancer
79	Daniel, John	9/12	M	S	AL	Mar	child	Hives
96	Johnson, Rebeca	43	F	M	SC	Apr	Keep House	Disease of womb
108	Harris, Jas M.B.	11/12	M	S	AL	May 70		Hernia
2	Smith, Samuel H.	35	M	M	GA	Sep	Farmer	Dispesia
117	Odel, Amanda	34	F	M	AL	Nov	Keep house	DropsyPericardium
117	Odel, Silvanas	1/12	M	S	AL	Nov	Infant	Hives
14	Medow, Mary	84	F	W	VA	Aug	Retired house	Keeeper Flux
28	Perry, William	1/12	M	S	AL	May	Infant	Bold Hives
36	Roberson, William T	3/12	M	S	AL	Apr		Inflam Brain
41	Gooden, John W	3/12	M	S	AL	Oct		Difthery
73	Perkins, William T	15	M	S	GA	Aug	Farmer	Kill by Horse
111	Landers (blank)	1/12	F	S	AL	Jan		Bold Hives
122	Tollerson, Nancy E	1/12	F	S	AL	May		Croup
12	Verdin, Mary E.	18	F	S	GA	March	Work in house	GeneralDisability
23	Brewer, John	59	M	M	GA	May		Paralisis
72	Camp, Thomas	40	M	M	GA	July		Consumption
97	Morris, Joseph	1/12	M	S	AL	May		Hooping cough
102	Wise, Jsa	65	F	M	NC	Dec	Keep House	Typhoyd fever
55	Gibbs, Wm H	12	M	S	AL	Mar		Consumption
73	Bell, William M.	77	M	M	SC	Apr	Farmer	Drown accidently
Total Deaths 27 - 1 black male, 1 black female								
Township 1, Range 1 East							G.M. Fowler, Ass't Marshal	
8	Vaughn, Louisah	6	F		AL	unk	at Home	Congestion of Brain
15	Welborn, Ann	67	F	W	AL	June	Keep house	Congestion of Lungs
43	Towery, George W.	7	M		AL	Aug	at Home	Infl. of Bowels
53	Cothram, Jane	3	F		TN	Sept	at Home	Typhoid Fever
69	Turner, William	27	M	M	AL	Sept	Farmer	Consumption
133	Fowler, William H.	59	M	M	AL	Decr	Farmer	Inf. of Stomach
143	Simms, Sarah J.	31	F	M	TN	Sept	Keep house	Consumption
"	" Sarah J.	2/12	F		AL	Oct		Inflamation ^{of} Brain

(continued)

Mortality Schedule (-continued-)

SCHEDULE 2. Persons who Died during the Year ending 1st June, 1870, in <u>T 1, R 1 E</u> in the County of <u>Madison</u> , State of Alabama, enumerated by me, <u>G.M. Fowler</u> , Ass't. Marshal.								
1	2	3	4	6	7	10	11	12
	Total Deaths 11 - 1	black	male,	2	black	females		
			**	*	**	**	**	**
	Township 2, Range 1	East					G.M. Fowler	Ass't Marshal.
142	Prewit, Marier M.	48	F	M	AL	Mar	Keep house	Rheumatism of Heart
193	Wilson, Sarah A	32	F	W	TN	May	no occupation	Consumption
213	Brooks, Sallie	28	F	M	AL	Sept	Keep house	Congestive Chill
	Total Deaths 14 - 3	black	males,	7	black	females,	1 mulatto	female
			**	*	**	**	*	*
	Township 3, Range 1	East,	Subdivision #53				Thos J. Taylor,	Ass't Marshal
39	Tipton, Appleton	26	M	M	AL	Dec	Farmer	Consumption
40	Beadle, John	30	M	M	AL	Sept	Farmer	Hip joint, disease of
45	Hunter, James	41	M	M	AL	July	Farmer	Consumption
194	Knowland, Amanda	2	F		AL	Sept		Dysentery
196	Keennon, Alexander	76	M	M	GA	May		Dropsy
196	Keenon, Mary	56	F	M	GA	March		Measles
--	Seay, Lee	1/12	F		AL	March		Measles
158	Davis, Daniel	1	M		TN	Sept		Diarrhea
--	Netherland, Mattie	4/12	F		AL	Mar		Croup
203	Brown, Martha M	60	F		NC	June		Heart Disease
--	Coffee, Sarah	74	F		NC	June		Disease of throat
204	Edwards, Catherine	1	F		AL	May		Croup
--	Ford, Jane	18	F		AL	June	Farm Lab	Croup
	Total Deaths 28 - 6	black	males,	9	black	females		
			**	*	**	**	**	**
	Township 1, Range 2						G.M. Fowler,	Ass't Marshal
9	Yarbrough, Martha L.	2	F		AL	Oct		Congestive Chill
13	Page, Glenna	3/12	F		AL	June		Hives
14	Page, Albert	5/12	M		AL	Mar		Infl of Bowels
69	Johnson, Margaret A.	4	F		AL	Aug		Croup
88	Campbell, Frances M.	58	F		AL	Sept	No occ.	Pneumonia
126	Pitcock, James S.	47	M	M	TN	Sept	Farmer	Hepatitis
139	Rich, Mary	80	F	M	NC	Apr	No occ.	Congestion of Lungs
237	Howard, Robt J.	2	M		AL	Nov		inflammation of Brain
--	" , Richard Jr.	8	M		AL	Feb		Typhoid Fever
250	Drake, Hugh W.	2	M		AL	Jany		Pneumonia
272	Brumblow, Margaret	8	F		GA	Aug		not known
"	" , Jackson	3/12	M		AL	Apr		not known
274	Green, Mary E.	2	F		AL	Sept		congestion of Brain
	Total 15 Deaths - 1	black	male,	1	black	female		
			**	*	**	**	**	**
	Township 3, Range 2	East					Thos J. Taylor,	Ass't Marshal
--	Harrison, Benjamin	1/12	M		AL	July		Whooping cough

(continued)

Mortality Schedule (-continued-)

SCHEDULE 2. Persons who Died during the Year ending 1st June, 1870, in T3, R2E in the County of Madison, State of Alabama, enumerated by me, Thos. J. Taylor, Ass't. Marshal.

1	2	3	4	6	7	10	11	12
64	Walls, Mary E.	34	F	W	AL	Feby	no occ.	Consumption
88	Glover, Ida L.M.	4	F		AL	Nov		Whooping Cough
113	Tipton, Mary E.	1	F		AL	July		Inflamation-Bowels
147	Martin, James	2	M		AL	Apr		Croup
149	Ragsdale, Sallie	47	F		AL	Apr		Erysipilas
148	Ragsdale, William	1/12	M		AL	Apr		Hives
Township 2, Range 2 East (same page)								
6	Martin, Alice	7	F		AL	Sept		Inflam of Brain
"	Miller, Thomas	11	M		AL	Apr		Pneumonia
5	, Rebecca	21	F	M	AL	Dec	Keep house	Consumption
105	Saint, John	55	M	M	AL	Aug	Farmer	Interm. Fever
103	Bragg, Martitia	2	F		AL	July		Scrofula
92	Barley, Joseph	3/12	M		AL	May		unknown
107	Baker, Peter S.	55	M	M	AL	Sept	Farmer	Liver Disease
162	Rigney, Mary C.	20	F		AL	May	no occ.	Consumption
Total Deaths 16 - 1 mulatto female			* * * * *					
Township 2, Range 1 West							Robert H. McMullen,	Ass't Marshal
81	Thompson, Samuel	23	M		AL	Sept	Farmer	Interm. Fever
87	Lindsay, Sarah	19	F		AL	May		Pneumonia
Total 15 Deaths - 7 black males, 6 black females			* * * * *					
Township 3, Range 1 West							Robert H. McMullen,	Ass't Marshal
197	Allison, Samuel	52	M	M	AL	May	City Tax Collector	Dropsy
174	McCoy, Elizabeth	27	F	W	AL	July		Consumption
182	Price, Mary	2	F		AL	Aug		Cholera Infantum
201	Pitman, Anna	2	F		AL	July		" "
217	Linzly, Caldonia	20	F		AL	May	Dom Servant	Pneumonia
228	Baker, Nellie	8/12	F		AL	Oct		Cholera Infantum
269	Scrimsher, Robert	15	M		AL	"	Farm Lab.	Cong. of Brain
274	Fulington, Mary	4	F		AL	Feb		Measels
"	, Morgan	1	M		AL	"		"
Total Deaths 17 - 3 black males, 5 black females			* * * * *					
Township 4, Range 1 West							Justin Rouayne,	Ass't Marshal
2	Fowler, Joseph B.	62	M	M	VA	Aug	Well Digger	Pneumonia
79	Carmichael, James	23	M		AL	July	Farmer	Dropsy of Peri-
79	Carmichael, George	19	M		AL	Nov	Farmer	" cardium
118	Pettigrew, Louana	1	F		AL	Feb		Pneumonia
398	Spauding, Jonathan	36	M	M	IL	Jan	Carpenter	Pneumonia
Total Deaths 31 - 11 black males, 11 black females, 3 mulatto males, 1 mulatto female			* * * * *					

(continued)

Mortality Schedule (-continued-)

SCHEDULE 2. Persons who Died during the Year ending 1st June, 1870, in T3, R 2W in the County of <u>Madison</u> , State of Alabama, enumerated by me, <u>Robt. H. McMullen</u> Ass't. Marshal.								
1	2	3	4	6	7	10	11	12
7	Knox, Sarah	20	F		AL	Aug		Consumption
15	Johnson, Lucy	1	F		AL	March		Cholera Infantum
17	Pearson, Richard	9	M		AL	Feb		Froze to death
19	Smith, Martha	23	F		AL	May	Dom Servant	Pneumonia
42	Seward, Susan	66	F	W	VA	Sept	Nothing	Consumption
42	Landman, Ruth	22	F	M	AL	April	Keep House	"
62	Pender, Eliza	18	M		AL	"	Farm Lab.	Congestive Chill
80	Drake, John N.	61	M	W	TN	May	Farmer	Jaundice
Total Deaths 9 - 1 black female					* * * * *			
Township 3, Range 2 West							Justin Rouayne	Ass't Marshal
11	McCreary, George B.	20	M		AL	April	Farmer	measles
34	Tribble, Nancy	26	F		AL	Feb	Seamstress	Consumption
Total Deaths 2					* * * * *			
Township 4, Range 2 West							Justin Rouayne	Ass't Marshal
10	Russell, Lorenzo	50	M	M	AL	Oct	Farmer	Pneumonia
21	Carter, --	--	F		AL	May		Still Born
35	Totten, Nancy	63	F	W	TN	Mar	Seamstress	Epilepsy
35	Hall, Margaret	26	F	M	TN	Apr	Keep House	measles
35	Totten, Susan	24	F	M	TN	May	Keep House	Pneumonia
56	Bodeley, Lucinda	75	F	W	unknown	Nov	Keep House	Congestive Chill
130	Ray, Sarah	1	F		AL	July		Croup
150	Crutcher, Joseph	26	M	M	AL	Mar	Farmer	Measles
163	Crutcher, Margaret	7/12	F		AL	Feb		Whooping Cough
197	Doughit, Julia	1/12	F		AL	May		Convulsions
200	Grubb, Ida	5	F		TN	Apr		Measles
201	Grubb, Ellen	1	F		AL	Aug		Measles
Remarks: House 56 not occupied since the death of Lucinda Bodeley.								
Total Deaths 35 - 12 black males, 9 black females, 1 mulatto male, 1 mulatto female					* * * * *			
Township 5, Range 2 West							Justine Rouayne,	Ass't Marshal
5	Rowe, Maria J.	55	F	W	VA	July	Keep house	Pneumonia
141	Lewis, William	3	M		AL	Apr		Pneumonia
155	Watkins, Martha	50	F	M	NC	Aug	Keep house	Cancer of Breast
183	Campbell, Matilda	2	F		AL	Oct		Hydrocephalus
Total Deaths 35 - 11 black males, 14 black females, 4 mulatto males, 2 mulatto females					* * * * *			
Township 4, Range 2 West							Justine Rouayne,	Ass't Marshal
282	Andrews, --	--	M		AL	June		Still Born

(continued)

Mortality Schedule (-continued-)

SCHEDULE 2. Persons who Died during the Year ending 1st June, 1870, in T4, R2W in the County of <u>Madison</u> , State of Alabama, enumerated by me, <u>Justin Rouayne</u> , Ass't. Marshal.								
1	2	3	4	6	7	10	11	12
283	Dedman, May L.	6	F		AL	Nov		Hydrocephalus
294	Lipcomb, Caroline	36	F	M	VA	Aug	Keep house	Child Birth
306	Wilmore, William	1/12	M		AL	Dec		Confulsions
315	Strong, Walter	1	M		AL	May		A. Diarrhea
316	Bibb, James H.	44	M	M	AL	Apr	Farmer	Pneumonia
Total Deaths 8 - 1 black male, 1 black female								
			* *	* *	* *	* *		
Huntsville, Ward 1							Wm Jay Franks	Ass't Marshal
30	Reedy, John H.	60	M	M	AL	Apr		Aicites (?)
37	Hill, William	55	M	W	AL	May	Shoemaker	unknown
64	Ludwig, Henry	9/12	M		AL	July		Disease of Bowels
(Father born in foreign country)								
68	Shaffer, Elizabeth	42	F	M	Saxony	Aug	Keep house	Bilious Fever
(Father and mother born in foreign country)								
166	Lasley, Margaret A.	22	F	M	AL	Nov	Keep house	Heart Disease
179	Houk, India	11	F		AL	June		Measles
205	Sullivan, Rosa	4/12	F		AL	Apr		Smothered
231	Paine, Francis	39	M	M	VA	Nov	Barkeeper	Consumption
240	Wolf, --	24	M		Prussia	Apr	Whiskey Rectifier	Infection of leg
(Father and mother born in foreign country)								
244	Jones, --	1/12	F		VA	Aug		Croup
248	Bar, Elijah	28	F	M	SC	Mar		Consumption
263	Culp, Charles	14	M		VA	July		Lock jaw
290	Clark, Samuel S.	56	M	W	NY	May	Plasterer	Consumption
Total Deaths 35 - 3 black males, 4 black females, 8 mulatto males, 7 mulatto females								
			* *	* *	* *	* *		
Huntsville, Ward No. 2							Geo. W. Dennis	Ass't Marshal
42	Elgin, Wm F.	43	M		AL	May	Book keeper	Acute Rheumatism
50	Erwin, Matilda	19	F		AL	Nov		Consumption
89	Bradford, David	76	M	M	VA	Oct		Diarrhea
102	Neely, James	65	M	M	NC	Feb	Pump maker	Pneumonia
102	Neely, Ada	20	F		AL	July		Consumption
103	Shanklin, Samuel	52	M	M	VA	July	GroceryMerchant	Ant Apoplexy
110	Warwick, Lucretia	76	F	W	PA	Aug		Old age
113	Hamlet, Robert	35	M	M	AL	June	R.R. Employee	Pneumonia
125	Leftrich, Neil (?)	57	M	M	VA	Jan	TinSmith	Pneumonia
125	Drake, Hugh	3	M		AL	Jan		Croup
136	Fariss (?), Wilson	44	M	M	AL	Sep	Bookkeeper	Congestive Chill
147	Conway, James	Infant	M		AL	Nov		Interm. Fever
(Father of foreign birth)								
149	Mann, Hannah	65	F	W	TN	Sept		Consumption
166	Cooper, Allen	69	M	W	NC	Sept	Ex-Merchant	Inf. of Kidneys
168	Rogers, John	42	M		PA	Apr	Clk in P. Court	Pneumonia
168	Rugg, Adalade	1	F		AL	July		Teething
193	Loving, George	46	M	M	AL	March	Carpenter	Pneumonia
116	Hinds,	1	M		AL	June		Teething
120	O'neal, Rosalie	56	F	W	AL	May		Consumption
Total Deaths 25 - 1 black male, 3 black females, 2 mulatto females								
			* *	* *	* *	* *		

(continued)

Mortality Schedule (-continued-)

SCHEDULE 2. Persons who Died during the Year ending 1st June, 1870, in <u>Huntsville Ward 3</u> in the County of <u>Madison</u> , State of Alabama, enumerated by me, <u>George W. Dennis</u> , Ass't. Marshal.								
1	2	3	4	6	7	10	11	12
3	Donegan, Charles (Father and mother born in foreign country)	28	M		AL	May	Lawyer	Disease of Stomach
13	Duncan, James	49	M	M	AL	Oct	School Teacher	Pneumonia
13	-- , John	1	M		AL	March		Burn
24	Cowles, Ebenezer	69	M	M	CN	May	Collector	Cholera
24	Atwood, George	42	M		NH	July	Silver Smith	Disease of Bowels
35	Dentler(?), Infant (Father and mother born in foreign country)	1/12	M		AL	Apr		Croup
63	Seat, Cora	2	F		AL	July		Disease of Brain
Total Deaths 7								
--End Madison County, Alabama 1870 Mortality Schedule--								



DUBLIN-GOOCH CEMETERY

This cemetery is located about .3 mile Northeast of the intersection of Old Madison Pike and Hughes Road. Found by Bill and Beverly True Edens, it was copied by P.B. and Kathy Keel, 25 December 1978.

The first two inscriptions are on one stone:

1. My Nephew William J. Dublin son of James and Ellin Dublin born December 9, 1827, died August 2, 1843, aged 16 years, 8 months, 22 days. Blessed are they that die in the Lord.
2. My brother George W. Gooch son of Roland and Elizabeth Gooch born December 15, 1816 died August 7, 1839. Aged 23 years, 7 months and 8 days. Blessed are they that die in the Lord.
3. My mother Elizabeth Gooch daughter of William and Martha McGhee wife of Roland Gooch born April 16, 1780 died February 25, 1858, aged 77 years, 10 months, 9 days. Blessed are they that die in the Lord.
4. My father Roland Gooch son of James Gooch born April 22, 1778 died August 29, 1850, aged 72 years, 4 months, 7 days. Blessed are they that die in the name of the Lord.
5. Susan C. Gooch born June 23, 1833 died July 3, 1912. The Gates of Heaven For Her Shall Open Wide.
6. N.M. Gooch born February 2, 1822 died December 20, 1901.
7. Katie S. Stewart born April 2, 1897 died August 28, 1904.

There were several more graves, but no markers.



Marshall



ORPHAN'S COURT

1836 - 1837

(Eighth Installment)

This 276 page volume is located in the Marshall County Courthouse, Guntersville, Alabama. It is a record book although labeled "Orphan's Court Minutes." Abstracted by Yvonne Spence Perkins. Continued from Valley Leaves, Volume 16, Number 1 (September 1981).

Pages 72-83 Estate of John M. Cabiness, Deceased.
 30 Aug 1837. Letters of Administration are applied for and granted to Charles P. Cabiness and Daniel S. Dickinson. Bond: \$5,000. Security: John M. Tate.

Administrators are ordered to present an inventory of goods and chattles and credits of estate. Witness Richard S. Randles, Court Clerk, 30 Aug 1839. Issued 30 Aug 1837.

Obligation bond of \$5,000 sworn to by administrators and John M. Tate before Louis Wyeth, Judge of County Court on 30 Aug 1837.

30 Aug 1837. Wm. H.E. Wheeler, Joseph G. Garrett and James H. Beard are appointed appraisers of the estate. They submit appraisal of \$144.50 on 16 Sept 1837.

List of sales for the estate of John M. Cabiness, deceased:

Wm. Wellborn	J.S. Wellborn	Wm. B. Jones
Jas. M. Moore	Wm. Smith	Wm. M. Griffin
Richd. Griffin		

Sworn to by Charles P. Cabiness, one of the administrators of the estate of John M. Cabiness, deceased, 1 June 1838.

The following accounts are due and unpaid:

John S. Allen	John W. Wakefield
Benj. F. Steel	John C. Johnson
Wm. McKee	Abner H. Price
James Sweeney	Jas. M. Macfarlane
Jesse Kile	Foster Paris
J.S. Wellborn	Lewis Armstrong
Wm. L. Mozely	L.D. Boshart
Jesse Allen	James Davis
Wm. Tidwell	Neville Sutton
Chas. C. Wellborn	Hiram C. Whitney
Jonathan Peters	James P. McLemore
Wm. Smith	Abner Vaughn
James Murphy	Mat S. Allen
Garrett & Darnes	John M. Tate
John Rickles	Timothy Boggess
Wm. Mayfield	Charner Sorter
John Whitley	T.K. Conley
James McKinley	Bart Smith
M.P. Williamson	Archd. McNeal
Samuel Burns	L.D. Parrott

(continued on next page)

Orphan's Court, 1836-1837, continued

Estate of John M. Cabiness, continued

Wm. S. Johnson	Wm. H. Wyatt
Fletcher <u>Judge</u> (or <u>Jordan</u>)	Green Smith
Asa Chapman	Johnathan Pipkins
Joshua Johnson	Toliver Shoemate
John Short	Jesse Elmore
John Gifford	James Ring
Bede Woodall	John Finley
John Province	Wm. Rose
Thos. D. Johnson	Jesse A. Smith
James Martin	Pines R. Ingram
Zephraniah Gideon	Samuel Allen
W.W. & J. M. Macfarlane	Gustavus Johnson
S.D. Rainey	Wm. Sims
Buck Woodey	J.J. Sublett
Wm. Arnott	John C. Norman
David H. Campbell	Richard Williams
Brownlow Carpenter	A.R. Dickinson
Abraham Birdwell	A.R. Rivers
Robert Davis	Jesse Upton
Booker Smith	John Brim
John L. Downes	Richard Ritchie
Nelson T. Philips	Lewis Simmons
Charles Higdon	Johnson & Dickinson
John Owen	David Duncan
Kelly (Red Hill)	Abraham Larue
Benj. Roden	Stephen Newman
Felix T. Allen	Wm. M. King
Thomas J. Moore	David Ritchie
Richard Griffin	Shelton R. Roglan
Thomas Harris	Wm. N. Griffin
Phelan Strand	Willis Stockton
John Blackwood	Wilkins Conalley
Holloway Powers	Chasen Cheek
Henry Norwood	Wash. T. May
Josiah Davison	Doctor Wright
Alexr Riddle	Karr B. Glascock
Wm. Ore	Green Hamilton
Felix Smith	Mary Obar
James Allen	A.C. Macfarlane
Saml. Tyler	James M. Moore
James McDavid	Jane Williams
James Kennemore	Wm. P. Darnes
John S. Goforth	Kitchen Sullivan
John Barclay	Cornelius Allen
Pleasant Nichols	Benj. Sharp
Wm. Cordell	Wm. H.E. Wheeler
T.B. Rector	B. & D.S. Dickinson
Adam Coxe	Richard Neeley
David S. Walker	Marshall Holly
Gross Scruggs	John Rhea
Reese Price	Henry F. Scruggs
Wm. Wellborn	Alfred Howlet
John Bradley	H.A. Russell
Billy Whiteman	John W. West
Andrew Ring	

The following notes are due the estate:

Johnson & Blackwood

(continued on next page)

Orphan's Court, 1836-1837, continued

Estate of John M. Cabiness, continued

Wm. M. Cabiness	Neville Sutton
Thomas Fry	S. Dougan
James Anderson	Henry Norwood
order on Boshart	Thos. D. Johnson
John C. Johnson	Zepheniah Gideon
F.T. Judd	Andrew Moore (2)
Abner Mayfield	James Murphy
Alexander Obar	B. Smith
S. Rayburn	Henry Smith (2)
Thomas S. Tidwell	B.S. Parsons
George Jackson	

Cash received from:

J. Davidson
 Henry Smith per Jas Finley on exr. against R.S. Randles
 James Price (on note)

Credits are asked to be allowed for funeral and coffin expenses, money collected from accounts, notes and sale of personal property, legal expenses, etc.

Court orders that Charles P. Cabiness and Daniel S. Dickinson, administrators for estate of John M. Cabiness, deceased, dispose of personal estate by public sale. 30 Aug 1837.

1 Dec 1838. Danl. S. Dickinson resigns as administrator.

1 Dec 1838. C.P. Cabiness resigned as administrator of the estate.

Court receives the resignations of Daniel S. Dickinson and Charles P. Cabiness. 28 Jan 1839.

28 Jan 1839. Percival M. Bush, Sheriff of Marshall County, is appointed administrator de bonis non of the estate.

P.M. Bush is ordered to pay (blank) to the Clerk and Judge and to Messrs. Wyeth and Webster, attorneys, the sum of \$30.

Court ordered P.M. Bush to be administrator of the estate of John M. Cabiness, deceased, by his paying bond to be approved by the court. 6 Mch 1839.

Percival M. Bush refuses to accept the administration of the estate of John M. Cabiness, deceased, and files notes of his own against the estate. The same are received and Bush is released. 9 Mch 1839.

Court appoints Joel Higgins, the new Sheriff of Marshall County, administrator de bonis non for the estate of John M. Cabiness, deceased. 8 Apr 1839.

Court orders Joel Higgins to pay the Clerk and Judge cost (no amount given). Also to Webster & Wyeth, attorneys, \$30. 8 Apr 1839.

5 Mch 1840. Washington T. May, Judge of the Orphan's Court has received final settlement from Joel Higgins, administrator de bonis non of the estate of John M. Cabiness, deceased, proposed by Louis Wyeth and Thomas Barclay, commissioners appointed to settle insolvent estate.
 (continued on next page)

Orphan's Court, 1836-1837, continued

Estate of John M. Cabiness, continued

An inventory list of the estate includes the sales; accounts; notes; cash received from Henry Smith per Jas. Finley vs R. Randles; Dickinson & Johnson; J. Davidson; Jas. Price; Amount on note on Wm. M. Cabiness not presented; Amount of account on Mat. S. Allen not presented; other notes and accounts including amount paid for Coffin to Jas. May.

Amount of offsets to notes: Garrett & Dames, Booker Smith and W.T. May.

(Note here states: "Transferred to Pages 207 to 215.")

Pages 84-90

Estate of Foster D. Paris(h), Deceased

8 Nov 1836 John Blackwood applies for and is granted Letters of Administration for estate. Bond: \$1,000. Securities: Geo. W. Allen and Peter S. Tidwell.

Court orders Blackwood to make true inventory before expiration of three months. 8 Nov 1836. Richard S. Randles, Esq., Clerk.

8 Nov 1836. Administrator and securities make obligation bond before W.T. May, Judge of County Court.

List of appraisal is given 8 May 1837. Sale of purchasers lists:

R.S. Randles	John S. Goforth
James Paris	Gross Scruggs
Abram Spencer	James Rose
John Thomas	Elizabeth Paris

15 Dec 1836.

7 Apr 1837. Account of sale is sworn to R.S. Randles, Clerk, by administrator.

John Blackwood, administrator of the estate petitions the Judge, Louis Wyeth, that the appraisers of the estate have not returned the same for land on the south side of the Tennessee River in the Cherokee Nation and some other parcels of personal property.

Court issues order of appraisement to John Ross, Lewis Stephens and John S. Boggess for the property of deceased, 28 Apr 1837.

Court appoints Andrew Turner, Tobias Derrick, Sen., and Karr Bailey appraiser of the personal property of decedent. 8 May 1839.

23 May 1837. Andrew Turner and Karr Bailey return appraisal of \$300.00.

John Blackwood, Administrator of the estate of Foster D. Paris, deceased, files accounts which mention note on William Forsyth.

"John Blackwood Administrator of the estate of Foster D. Paris, deceased, files his resignation of said administration as follows"
(No further record is recorded here. Page is blank.-Editor)

(To Be Continued)





Morgan



MARRIAGE BOOK "A"

Morgan County Marriage Book "A" is the earliest marriage book found in this county and covers the period from July 18, 1821 through March 1, 1861. This book begins with marriage No. 132 so we can assume there are at least 131 of the earliest marriages missing. [Copied and contributed by Dorothy Scott Johnson.]
This series began in Valley Leaves, Volume 16, Number 1, September 1981.

PART 3

<u>No.</u>	<u>Groom</u>	<u>Bride</u>	<u>Lisc.</u>	<u>Sol.</u>	<u>By</u>
353	William Jones	Cynthia Hill	2-16-1825	---	---
354	James Weaks	Dicy Hill	2-16-1825	---	---
355	John Tate	Ann Jones	1-27-1825	2-2-1825	Queen Moten, MG
356	Asa Wilks	Hester Barclay	3-9-1825	---	---
357	Edward Givens	Jane Givens	3-9-1825	3-10-1825	Jno. C. Hawkins, JP
358	John G. Wright	Mary Dement	3-16-1825	3-17-1825	Robt. Tapscott, JP
359	William Pride	Matilda Milwee	3-28-1825	3-31-1825	Thos. Sharp, JP
360	Richard Hudson	Lucinda Walden	12-3-1824	12-12-1824	Philip Archer, MG
361	Jonathan Sandlin	Isabella Wise	4-12-1825	---	---
362	Hardin Norwood	Sarah Parker	4-18-1825	4-29-1825	David McClung, JP
363	Henry Hill	Charity Austin	5-6-1825	5-9-1825	H. Wright, JP
364	John W. Harvey	Valinda Breedlove	5-9-1825	5-12-1825	Thos. Crow, JP
365	James Anderson	Ann Gardiner	5-12-1825	5-13-1825	Thos. Skidmore, JP
366	John Allen	Ann Simmons	5-2-1825	5-3-1825	Jno. McClannahan, JP
367	Charles M. Smith	Martha Reeves	5-16-1825	5-17-1825	"
368	Allen H. Rackley	Polly Garner Dean	6-4-1825	6-9-1825	M. Cyrus, JP
369	William Tunney	Polly Bain	6-4-1825	6-9-1825	"
370	David Martin	Elizabeth Campbell	6-27-1825	6-27-1825	Thos. Sharp, JP
371	William Blunt McClellan	Martha T. Roby	6-29-1825	6-30-1825	Jas. L. Sloss, MG
<u>371</u>	John J. Edwards	Jane Medford	6-29-1825	6-30-1825	James E. Matthews, MG
372	Harmon King	Phoeba Hensley	7-11-1825	7-14-1825	Thos. Crow, JP
373	John High	Sarah Stripling	7-23-1825	7-24-1825	J. C. Hawkins, JP
374	James Barbee	Sarah Reedy	8-4-1825	---	---

(continued next page)

Marriage Book "A", continued			<u>Lisc</u>	<u>Sol.</u>	<u>By</u>
375	Alexander Logan	Martha Smith	8-9-1825	8-11-1825	R. Tapscott, JP
376	Samuel Tucker	Ann Allen	8-10-1825	8-11-1825	T.W. McCarty, JP
377	Thomas B. Pride	Rebecca Sanders	8-15-1825	8-15-1825	N. Evans, JP
378	Jeddediah Stinson	Darcas Ray	8-20-1825	8-25-1825	Robt. Tapscott, JP
379	Lewis Parker	Elizabeth Webb	8-27-1825	8-28-1825	John McClannahan, JP
380	William H. Rackley	Nancy Smith	8-30-1825	9-1-1825	M. Cyrus, JP
381	John M. Hale	Mary Archer	8-30-1825	8-30-1825	John McClannahan, JP
382	Thomas Greene	Sarah Dunn	9-12-1825	Sept., 1825	---
383	John Holmes	Patsey Kyle	9-15-1825	9-15-1825	Edley Lynn, JP
384	Jesse Smith	Nancy Markham	9-21-1825	9-22-1825	N. Evans, JP
385	Durham Madkins	Malinda Love	9-24-1825	9-29-1825	Thos. Crow, JP
386	Joseph Rector	Harriet B. Heard	9-22-1825	---	---
287	Samuel Francis	Elizabeth Harwood	9-28-1825	9-29-1825	Thos. Smith, MG
388	Isaac Sadler	Mary Simpson	10-6-1825	10-6-1825	J. S. Slass, MG
289	Dornton McCarley	Matilda Phillips	10-7-1825	Oct., 1825	H. Wright, JP
390	Nicholas Beauchamp	Mary King	10-10-1825	10-12-1825	W. Evans, JP
391	John Foster	Esther Roland	10-12-1825	10-13-1825	T.W. McCarty, JP
392	Jonathan Dansby	Sarah Jagers	10-14-1825	10-16-1825	Thos. Crow, JP
393	Miles McDowell	Ann Acock	10-19-1825	---	---
394	Moses Somers	Mary Livingston	10-24-1825	Oct., 1825	Jas. Ferguson, JP
395	Robert Patterson	Malinda Clark	10-27-1825	---	---
396	Benjamin Allen	Elizabeth Sanders	11-6-1825	11-9-1825	N. Evans, JP
297	William Mahan	Irabell Martin	11-12-1825	11-12-1825	D. Ballew, JP
398	Willis A. Reeves	Harriet C. McDowell	11-12-1825	11-15-1825	John H. Bibb, JP
399	Carroll Jeffreys	Parmelia Stockton	11-19-1825	12-1-1825	Thos. Skidmore, JP
400	Jonathan L. Owens	Cynthia W. McElderry	11-22-1825	11-25-1825	"
401	Ambrose Flinn	Sarvenah Speagle	12-3-1825	12-6-1825	R. Tapscott, JP
402	William Nunn	Sarah Wilks	12-6-1825	12-9-1825	"
403	George Cannon	A. Wagoner	12-17-1825	12-18-1825	G. W. Hale, JP
404	Daniel Matthewson	Mary Lauderdale	12-17-1825	12-20-1825	M. Cyrus, JP

(continued on next page)

Marriage Book "A", continued			<u>Lisc.</u>	<u>Sol.</u>	<u>By</u>
405	John Gandy	Sarah McKinnis	12-17-1825	12-29-1825	M. Cyrus, JP
406	Anderson W. Childers	Sarah A. Newman	12-20-1825	---	---
407	Charles W. Peters	Sarah W. McClellan	12-22-1825	12-22-1825	Jos. L. Sloss, MG
408	Robert Flemming	Elizabeth Chapel	12-24-1825	12-25-1825	John McClannahan, JP
409	John H. Oden	Clarinda Welch	12-26-1825	---	---
410	Thomas Billingsly	Nancy Randolph	12-13-1825	3-2-1826	M. Cyrus, JP
411	Asa Hodges	Martha Ann Stovall	1-1-1826	1-2-1826	David McClung, JP
412	William W. Spence	Elvira E.C. Dandridge	1-3-1826	1-3-1826	Jas. L. Sloss, MG
413	William Raley	Mary Owen	1-17-1826	1-8-1826	Jno. H. Bibb, JP
414	Hezekiah Jurmon [Jarmon? German?]	Jinsey NeSmith	1-10-1826	1-10-1826	"
415	Green Berry Dickson [Greenberry?]	Alice Thompson	2-8-1826	2-9-1826	W. Evans, JP
416	Martin Kyle	Lucinda Couch	2-8-1826	---	---
417	Sevier Underwood	Charlotte Yeager	2-7-1826	2-12-1826	Thos. Crow, JP
418	Franklin South	Jane Berry	2-14-1826	2-14-1826	Thos. Brisco, MG
419	Green Ray	Catharine B. Collins	2-15-1826	2-16-1826	T. W. McCarty, JP
420	Zachariah Pulliam	Jane Thompson	2-27-1826	---	---
421	John S. Looney	Sally D. Currin	2-28-1826	3-2-1826	Thos. Brisco, S.M.G.
422	Daniel St. Clair	Pherebe Roland	3-9-1826	3-9-1826	John Henry, JP
423	Henry Basinger	Lucinda Watson	3-11-1826	---	---
424	McKinney Holderness	Elizabeth Luce	3-18-1826	---	---
425	Elijah Ellison	Catharine Pate	3-21-1826	3-21-1826	Edley Lynn, JP
426	William Young	Francis Simmons	4-3-1826	4-14-1826	T.W. McCarty, JP
427	Joseph Swann	Elizabeth Jagers	4-5-1826	4-6-1826	James Ferguson, JP
428	John Francis	Nancy McCrosky	4-11-1826	4-13-1826	Jno. C. Hawkins, JP
429	Thomas Crow	Ann Kinney	5-6-1826	5-7-1826	James S. Smith, JP
430	David K. Pace	Bathany Petty	5-8-1826	5-9-1826	H. Wright, JP
431	William J. Scott	Eliza R. VanDyke	5-11-1826	5-11-1826	Jas. S. Sloss, MG
432	Ezekiel P. Wallace	Sarah McCarley	5-20-1826	---	---
433	Ben Breedlove	Louisa Haney	6-5-1826	6-6-1826	James Ferguson, JP

(continued on next page)

Marriage Book "A", continued			<u>Lisc.</u>	<u>Sol.</u>	<u>By</u>
434	Peter Smith	Eloisa Echols	6-20-1826	6-20-1826	Edley Lynn, JP
435	David Davidson	Mary Bragg	7-15-1826	7-25-1826	M. Cyrus, JP
436	John Campbell	Sarah Eagan	7-17-1826	7-18-1826	H. Wright, JP
437	Davidson McNutt	Parmelia Sharp	7-17-1826	7-18-1826	Thos. Skidmore, JP
438	John Wright	Mary Clift	8-7-1826	8-8-1826	John Smith, MG
439	Bazel Weeks	Jane Harwood	8-10-1826	8-10-1826	Edley Lynn, JP
440	Thomas C. Matkin	Lucinda Love	8-15-1826	8-15-1826	James L. Smith, JP
441	Job Barnard [Bannard?] Mary Roland		8-25-1826	8-26-1826	G. W. Hale, JP
442	Arthur Markham	Catharine Clark	8-30-1826	8-30-1826	N. Evans, JP
443	Wesley Bell	Elizabeth Bell	9-4-1826	9-4-1826	Jas. Ferguson, JP
444	John Jeffers	Mahala Castleberry	9-28-1826	9-28-1826	N. Evans, JP
445	Samuel Innmon	Mary Williams	9-14-1826	9-14-1826	James Gillespie, JP
446	Thomas J. Lauderdale	Barbary McCaleb	9-30-1826	10-5-1826	M. Cyrus, JP
447	James J. Benham	Jane Cowan	10-8-1826	10-8-1826	N. Evans, JP
448	John E. Irwin	Susan M. J. Montgomery	10-16-1826	10-16-1826	John Smith, MG
449	John P. Moore	Elizabeth Kirkland	10-18-1826	10-19-1826	Jno. C. Hawkins, JP
450	Joseph H. Gillespie	Sarah Lay	10-26-1826	10-26-1826	Thos. Sharp
451	John Noaks	Nancy Foran	10-28-1826	---	---
452	Richard Gillentine	Liana [Lidna?] Stovall	11-18-1826	11-19-1826	Jo. Herring, JP
453	John Innman	Mary Alexander	11-20-1826	11-21-1826	James Ferguson, JP
454	James White	Elizabeth Musgrove	11-30-1826	11-30-1826	Wiley Galloway, JP
455	John Simpson	Mary Wise	12-4-1826	12-4-1826	Wiley Galloway, JP
456	Samuel Woody	Truelove [Freelove?] Arbaugh	12-4-1826	12-5-1826	Jno. C. Hawkins, JP
457	Dudley Dean	Lucinda Hays	12-5-1826	12-7-1826	J. B. McCrosky, JP
458	Barclay Flemming	Sophia Stuts	12-10-1826	12-10-1826	Wm. Skidmore, JP
459	John Clifton	Francis L. Elliot	12-18-1826	12-22-1826	John L. Townes, MG
460	William Keneda	Mary West	12-18-1826	12-19-1826	N. Evans, JP
461	Philip Watkins	Matilda M. Stovall	12-19-1826	12-20-1826	David McClung, MG
462	Joshua Bruson [Brison?] Elizabeth Johnson		12-21-1826	12-21-1826	Jno. C. Hawkins, JP

(Continued in June 1982 Issue)

Queries

Mrs. S. Drake Ellis, Query Editor

Queries are free to members. A maximum of 175 words per year per member is allowed. A maximum of 175 words per non-member may be published for a fee of \$2.00 (as space allows). All queries are edited and published at the discretion of the editor and we reserve the right to refuse to publish any query submitted. At least one full name, date and location should be included in each query. No "surname-only" listings will be published.

#749 PADGETT, ARNOLD. Joseph S. Padgett was b cal860 AL. 1st wf name unknown, their ch: Wyatt b cal881; Ada b cal885 possibly in Milam Co TX. He m. 2nd Mrs. Alice Arnold with ch: Frank b cal88; Fred b cal890; & Ora b cal892. Joseph & Alice ch: Charles b cal895; & Homer b cal900 TX. Need Joseph's par & siblings in AL. Will exch info anyone searching Padgetts.

STEPP, HARTGROVE. Need par of Achilles Stepp b cal809 KY. In Jackson Co AL 1850 with wf Malinda ?. Ch: James S. b cal836; Logan b cal841; Eliza b cal843; Andrew C. b cal844; Samantha A. b cal845; Arminda b ca 1847; & John C. b cal849. Dau Arminda m. William Daniel Hartgrove 15 Nov 1865, lived AL, TN, AR where Arminda died. He moved to Omaha, TX. Malinda bur in Legg Cem. Limestone Co AL. Headstone reads b 7 Oct 1818 d 26 Aug 1901 "Wife of A." Is Achillees bur there in unmarked grave?
* Pat Clark (Mrs. Robert), 5712 Wilkes Drive, Fort Worth, TX 76119.

#750 STANFORD, DAVIS, HARRISON, LUNSFORD, MOTT, HARRISON. Joseph A. (Joe) Stanford b 1831 KY or AL m. Elizabeth (Betty) Davis b 1834 TN. Grandison G. Harrison b 1816 NC m. Ellender Lunsford b 1820 VA. Rose Anna d/o Allen Mott m. Charlie A. Harrison in 1888 AL. Any info appreciated on any of the above.
* Verna M. Carroll, Route 2, Box 44-A, Amory, MS 38821.

#751 MASTERSON. Seeking data establishing John Patrick Guthrage Masterson who lived in TN & No. AL in early 1800's as grandson of Patrick Masterson, Revolutionary soldier who d in Owsley Co. KY in 1855.
* Helen M. Mason, Route 1, Dillsboro, IN 47018.

#752 CAGLE, ROSS. Littleton (Young?) Cagle b Montgomery? NC ca 1810 d Bledsoe, TN Mch 1889. Married ca 1835 Jackson? AL to Katie Ross. Looking for any/all of his/her ancestry back to immigration. Will gladly share my info.
* Grover Cagle, 1203 Lincoln, #12, San Rafael, CA 94901.

#753 HAMILTON, BLAGG. Need par of Isaiah Hamilton b 1798 possibly VA. In Lawrence Co AL in 1820. Married Frances Blagg 1829. Does he belong to the Huntsville Hamiltons?
* Charlotte C. Smith, 2791 Walker Lee Drive, Los Alamitos, CA 90720.

#754 GOTCHER, FULLER. Seeking info re Gotchers of Lawrence Co AL, especially Thomas, John & Jessie M. Gotcher. Thomas m. Mary Fuller 1837.
* Robert Gotcher M.D., 215 No. San Mateo Drive, San Mateo, CA 94401.

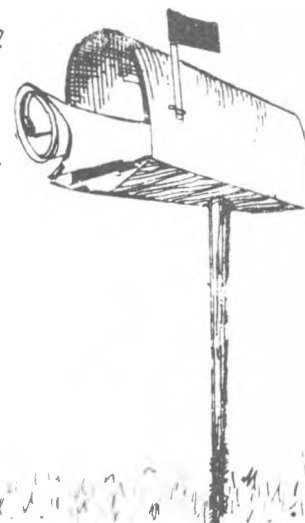

- #755 MURRAY, HUBBARD, NEWMAN. Elizabeth Murray b cal793 d ? m. Thomas Hubbard 8 Jan 1814 in Madison Co AL. Where are they bur & when? From Madison Co court records, her father was William O. Murray & his wf was Lucy M. What was her maiden name? Their ch: Mary; John A.; Sara A. m. ? Newman?; Ann; Virginia; Lucy; William O. (female); & Judy A. Need info re any.
- CLARK, HUBBARD. Who are par of Jane Clark m. William Murray Hubbard Sr 2 Apr 1844? He s/o Elizabeth & Thomas Hubbard.
* Gary Hadder, Rt. 11, Box 499, Lot 704N, Birmingham, AL 35210.
- #756 COCHRAN. My gr-gr-grfather was James Cochran b cal773 VA. To TN prob thru NC before 1807. To Madison Co AL early 1820's. In Talladega Co AL by 1834. Need contact with desc with more info.
* Mrs. Charlene McAllister, 2013 Kingston Place, Bakersfield, CA 93306.
- #757 LEEPER/LEIPER, WOOD/WOODS, McDANIEL, McAFEE, GRIZZARD, KEYS. Will pay 25 dollars for proof of the James Leeper line of Lawrence Co AL. James b 1780 d 1848 poss. AL m. Elizabeth Wood(s). He bought land in Lawrence Co 1818 & 1830. Had at least 10 ch, sons Samuel & Charles listed in 1830 census near James Leeper's home. Marriages of some ch listed in marriage records of Lawrence Co, m. into McDaniel, McAfee, Grizzard & Keys families. A son b in GA in 1800, dau b GA 1807, then fam moved to TN, possibly Marshall Co, later to AL. Some ch names: Samuel; Charles; James N.; Ann or Elizabeth Ann; Icephenia (Icey); Tranquilla (Trannie) & others.
* Mrs. J.P. McDaniel Sr., 4834 Winfree Drive, Houston, TX 77021.
- #758 FARRIS, GUNTER, HAMPTON, RUSSELL. John Farris m. Jennie Gunter d/o Hawkey Gunter and Dollie Russell (Cherokee Indians). Dau Nancy Farris b ca 1824 AL m. 27 July 1843 in Obion Co TN to Edmund Hodges Hampton. Who were his par? Appreciate any info re these families.
* Mrs. Robert Adams, 2121 Darlington St., Birmingham, AL 35226.
- #759 RICE, PRYOR, HICKMAN, POWERS, McCALLEY, HUNT. Would like to contact present owner of family Bible formerly property of Joel & Elizabeth Pryor Hickman Rice, both d 1830's. Bible prob in possession of Mrs. Tulliola Rice Powers McCalley Hunt at time of her death in Huntsville 1897. Desire info relative to births, deaths & marriages therein.
* Turner Rice, 3608 Ridgeview Drive, W., Birmingham, AL 35213.
- #760 BUTLER, McCLANAHAN, CONN, SMITH, PICKETT. James M. Butler m. Sally ? . Ch: Lewis (Louis) M. b 1809 KY d 1891 Freestone Co TX m. Margaret McClanahan; David C. b cal813 SC m. Mary R. McClanahan. Spouses d/o Catherine & Samuel M. McClanahan. The Lewis M. Butler ch: Preston Irvin b 1872 Montgomery, AL d 1916 Freestone Co TX m. Laura Joyce Conn; Mary J. b cal845 MS d prior to 1864; Calvin D. b cal846 MS d prior to 1864; Samuel H. b cal848 Shelby Co AL d & bur Dallas, TX m. Sarah/Sallie A. ? ; Angeline b 1859 Shelby Co AL d 1887 Freestone Co TX; Martha Izora b 1853 Shelby Co AL d 1906 Freestone Co TX m. Frank Smith; Leonard M. b 1855 AL d 1919 Freestone Co TX m. 1st Lizzie E. ? , m. 2nd Lou Ann Pickett. Need info on all except Preston Irvin Butler.
* Betty M. Chaney, P.O. Box 18462, Houston, TX 77023.
- #761 WATTERS, ROAN, RUSSELL. To all desc of Thomas Watters, Madison Co AL thru his sons Daniel, John & Thomas: Did Alcy Watters Roan have a twin sister? Why was Alcy Watters Roan (1802-1846) not permitted to keep her children, Catherine & John, after death of her husband, Jesse Roan in 1845? Did she have a communicable disease such as TB? What doctor in Sommersville, AL 'raised' John and did he also take Catherine? If not, who kep her until she m. John Russell?
* Evelyn R. Stern, 618 Shadwell, San Antonio, TX 78228.

- #762 COX, O'NEAL, GREASLAND, MITCHELL. Need info on John R. Cox b 9 Sept 1848 m. Mary Ann O'Neal b 28 Aug 1856. Migrated to AL in late 1870's. Parents were Arron Cox Jr b 20 May 1820 m. Pauline Greasland b 30 Dec 1821 and James L. O'Neal b 19 July 1834 m. Sarah E. Mitchell b 28 Dec 1839.
- KITCHENS, WALKER. Need info on Josiah D. Kitchens m. Susanna T. Walker.
* Mrs. Lois Lumpkin, P.O. Box 736, Hope, AR 71801.
- #763 BAKER, HOLBERT, SANDERSON, PETETE. Among relatives purchasing Limestone Co AL land 1820/21: John C. Baker b 1780 NC-T2 R6W; Joseph Holbert-T2 R6W; Lewis Sanderson T2 R5W; Barbary (?) Petete (Mrs. ?)-T2 R6W.
* Mrs. Louis O. Brackeen, 207 Villa Fontaine Apts, 1520 Carridale, S.W. Decatur, AL 35601.
- #764 BORUM, DAVI(D)SON, SCHULTZ, TATHAM. Lawrence Co: Wm. F. Borum b 1813 TN (where?), Hillsboro census 1880, died ? ; wife Roseanna, 1850 census, d before 1880. Need vital statistics. Edmund Borum b 1775 VA (where?), d after 1850; wife? parents? in Lawrence by 1830. Thomas R. Davison b 1833 AL (prob Limestone or Lawrence Co), parents b AL. Need vital statistics on all. Davison d Hillsboro 1888, m. 1870 Martha J. Borum (b 1846). Jno. Niles Schultz b 1849 Denmark?, in Memphis approx 1865, m. 1875 Courtland, Frances Tatham; both d 1885. Need married name and info about his sis Josephine (Josie) liv Memphis till about 1911. T.A. Tatham & Rebecca ? lived Courtland (died when?, etc.). 35th Ala. Vols, Co C (Civil War) records of survivors in Lawrence thru 1900 (Tatham Captain 1863).
* Rebecca Patterson, Rt. 3, Box 315, Fair Grove, MO 65648.
- #765 BYNUM, WATERS. John E. Bynum, who m. Sarah Waters in DeKalb Co, AL, later moved to Jackson Co. Sarah's father may have been Moses Waters. One Moses Waters shown in AL 1850 census index as in DeKalb Co, but could not locate on microfilm. Interested in correspondence with others researching these families and the Cokers who were in Bibb Co, AL at one time.
* Mrs. Willie Coker, Rt. 1, Marquez, TX 77865.



BOOK REVIEWS

Lois Robertann, Book Review Editor

1907 CONFEDERATE CENSUS: LIMESTONE, MORGAN & MADISON COUNTIES, ALABAMA, by Dorothy Scott Johnson. 1981. Published by Johnson Historical Publications, 2409 Gaboury Lane, Huntsville, AL 35811. 8½ x 11", soft cover, 67 pages, including index. Price: \$8.00 plus \$1.00 for postage and handling.

Mrs. Johnson, one of North Alabama's most prominent genealogical and historical researchers, has given us another very useful publication, the transcription of the 1907 Confederate Census for Limestone, Morgan and Madison Counties. Along with names and places of residence, general information includes birth dates and places as well as information about Service records. Also, Mrs. Johnson has thoughtfully included a copy of the 1907 Act which called for the enumeration of the Confederate Soldiers then residing in Alabama.

(Additional Book Reviews on page 150.)



Book Reviews



Lois Robertson, Book Review Editor

ALABAMA GENEALOGICAL SOCIETY MAGAZINE, Volume 14, Numbers 1-4, 1980. Dues of \$12 annually includes 4 issues of the Magazine and free queries to Mr. Bobby Walker, Treasurer, 728 37th Place North, Birmingham, AL 35222. 8½ x 11", 80 pgs.

This volume contains abstracts from state newspapers; the 1830 Perry County census; Abstracts of Selected Acts, Alabama Legislature, 1851-1852; Abstracts of Shelby County Will Book B, 1818-1841; Alabama Divorces Approved by State Legislature, 1818-1868. We found the Abstracts of Acts of Alabama to be very accurate but were disappointed in the Divorces which were not.

TROUP COUNTY, GEORGIA AND HER PEOPLE, Introductory Issue, Oct 1981, published quarterly by Family Tree Publications, 125 Vernon St, LaGrange, GA 30240. 8½ x 11", \$16.00. Indexed.

This first issue contains early history of Troup County; Troup County Marriages, Book A, 1828-1837; Will Book 1, 1832-1848; Deed Record A; information on early Troup County residents and queries. Future issues planned will include Census records, Family Bible records and pictures. Commercial advertising is included. Certainly people with Troup Co. connections will want to subscribe.

FAMILY LINKS - PAST AND PRESENT, Volume 1, Number 1, January 1981. Published three times a year in January, May and September by the Irish Genealogical Association. Initial membership fee, \$50.00 U.S., renewals \$25.00 U.S. 8" x 12".

This new journal with slick paper and colored pictures is an ambitious undertaking with an aim "to encourage and assist those members who wish to visit Ireland to trace their family history and to provide a personalised research service for those unable to do it themselves." This first issue contains an introduction to Irish genealogical research and an in-depth article on the Upper Ards Peninsula, County Down and its people. Additional information about tourism in Northern Ireland is included.

A STUDY OF METCALFS (ANDREWS & SMITH) by Clayton G. Metcalf. 1979. 408 North Rawls St., Enterprise, AL 36330. 6 x 9", hard cover, 647 pages including index. Price: \$20.00.

Mr. Metcalf has attempted in this one volume to bring together a great deal of information and material on Metcalf families - including all spellings. The author has not attempted to tie all families together. His own paternal line is covered quite extensively with anecdotes and pictures. Mr. Metcalf has included a lot of personal information which makes for a very readable family history.

SCRIPSIT by Virginia Hooper Barton. 1979. 8½ x 11", soft cover, 147 pages including index. No price given. Published by Thompson Printing Co., Albertville, AL, P.O. Box 550, Albertville, AL 35950.

This limited edition is a bibliography about people of Marshall County, Alabama. Books, magazines, periodicals and trade publications were covered but to be listed, an author must have been born, or lived at some time in Marshall County. Mrs. Barton has provided not only a bibliography but also has many interesting tidbits about the authors covered.

TVGS POLICIES

QUERIES - Free to members; \$2.00 each to non-members. Each member is entitled to one query per year; however, additional queries may be submitted and will be used as space is available. Please limit queries to 175 words or less. No surname queries, please. At least one full name, date, and location should be included in each query. We reserve the right to edit all queries. Send queries NOW. Work begins months before the date on the cover.

CONTRIBUTIONS - TVGS does not pay for contributions but welcomes genealogical material pertaining to our Valley counties (see front cover). Occasional articles concerning neighboring counties will be used. Families living in our counties prior to 1900 are of the most interest, genealogically speaking, so please do not send recent items.

To be considered for publication an item submitted must have a reliable reference - not be based entirely on "tradition." We do not want items copied from books now in print, however, such references may be used as footnotes to clarify items.

Valley Leaves is most interested in securing for publication the following types of items (send photocopy of original if possible):

Family Bible records (include title page with date Bible was published if page still exists), diaries, church records, military records, minister's records, cemetery readings (give location of cemetery and whether or not the listing is complete), courthouse records, old newspaper items, etc.

Contributions of Bible records, wills, etc., which include a photocopy of the original record plus a typed or handwritten transcription are usually published before records sent without a photocopy. We always reserve the right to edit.

BOOKS - Books will be reviewed in Valley Leaves only upon receiving a gift copy from the author; afterwards the book is given to the Huntsville Public Library. We do not accept paid advertisement.

MAILING ADDRESS - Please inform TVGS immediately of a change of address. *We will charge \$2.00 to redeem an issue undelivered at the last address in our files.*

SUGGESTIONS - TVGS welcomes any suggestions for improving our publication. Help us keep our standards high. Please re-check for accuracy any item you send to us. Notify us of unusual sources of material we might be permitted to publish in future issues of Valley Leaves.

Tennessee Valley Genealogical Society, Inc.
Post Office Box 1568
Huntsville, AL 35807-0568

Return Postage Guaranteed

Bulk Rate
U.S. POSTAGE
PAID
Huntsville, Alabama
PERMIT #708